 2 Bedrooms

 1 Bathroom

 1 Reception

 EPC Band D

Council Tax Band:
D £0.00 ()

 **ashtons**
for life's great moves

Spencer Street, St. Albans, Hertfordshire, AL3 5EG
£1,795 PCM

Superb character cottage in St Albans conservation area, moments from the vibrant City centre and close to the mainline station.

Description

Situated on a picturesque road, this stylish cottage offers a blend of modern style and period charm. The open-plan kitchen features high gloss units, dark stone worktops, an electric oven, hob, dishwasher, and washer/dryer. A floor hatch reveals a cellar for extra storage. The living area opens to a courtyard garden via large windows and French doors. The garden, with artificial lawn, is low maintenance and perfect for outdoor dining. On the first floor, there are two bedrooms; the larger includes fitted wardrobes. The contemporary bathroom features oversized tiling, chrome finishings, a backlit vanity unit, and a bathtub with shower. Located on Spencer Street, in central St Albans, it's ideal for commuters with proximity to both St Albans mainline and Abbey stations. Shops, bars, cafes, and restaurants are nearby. Council Tax band D: £2,155.11 for 2024/2025. Holding deposit: £414.23. Deposit: £2,071.15.

Location

Spencer Street is ideally situated in the centre of St Albans, equidistant to St Albans mainline station and the Abbey Station, perfect for London commuters. Enjoy a vibrant lifestyle with shops, bars, cafes, and restaurants right on your doorstep.





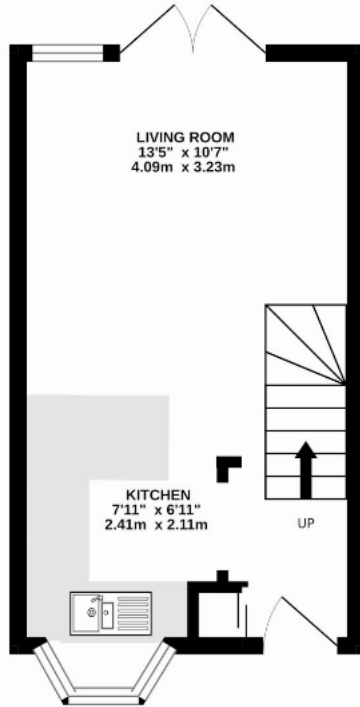

GROUND FLOOR
257 sq.ft. (23.9 sq.m.) approx.

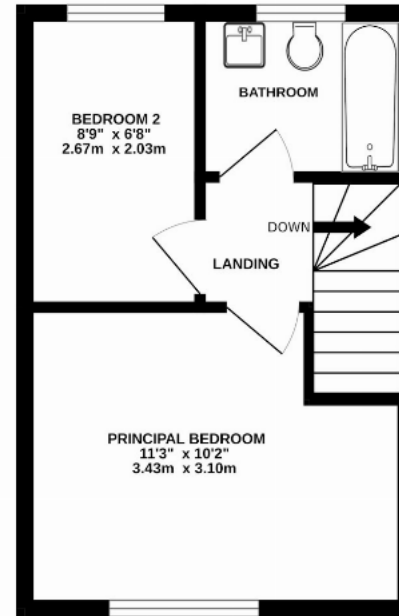

1ST FLOOR
257 sq.ft. (23.9 sq.m.) approx.

TOTAL FLOOR AREA : 514 sq.ft. (47.8 sq.m.) approx.

This floor plan is for illustrative purposes only. The measurement and position of each element is approximate and must be viewed as such

Important Information These particulars do not constitute an offer or contract in whole or part. The statements contained herein are made without responsibility on the part of Ashtons or the vendors and they cannot be relied upon as representatives of fact. In respect of floor plans, these are for illustrative purposes only. The measurement and position of each element is approximate and must be viewed as such. Intending purchasers should therefore satisfy themselves by inspection or otherwise as to their correctness. The vendors do not make or give, and neither Ashtons nor any person in their employment has any authority to make or give, any representation or warranty whatsoever in relation to this property. We offer a wide range of services through third party providers including solicitors, surveyors, removal firms, mortgage providers and EPC suppliers. We receive additional payments for administering suppliers quoting software and making referrals. You are not under any obligations to use these services and it is your discretion whether you choose to deal with these parties or your own preferred supplier. You should be aware the average payment we received in 2024 equated to £29.76 per referral.