



1 Bedroom



1 Bathroom



1 Reception



EPC Band C

Council Tax Band:
B £1,905.89 (2026/27)

 **ashtons**
for life's great moves

Northridge Way, Hemel Hempstead, HP1 2AF
£1,300 PCM

Spacious ground floor 1-bed flat with allocated parking, near Hemel Hempstead station & Boxmoor village. Ideal for commuters.

Description

This well-presented one-bedroom ground floor flat is available now. Recently refurbished, it is ideally situated on Northridge Way in a sought-after residential location. The property benefits from an allocated parking space along with additional visitor parking. The accommodation comprises a bright living area, fitted kitchen, double bedroom, and bathroom, offering a practical and comfortable home ideally suited to a single occupant or couple.

Location

Northridge Way, in a sought-after part of Hemel Hempstead, is close to the mainline station with direct links to London. Nearby Boxmoor village offers shops, cafés, pubs, and amenities, alongside lovely canal-side walks and open green spaces.







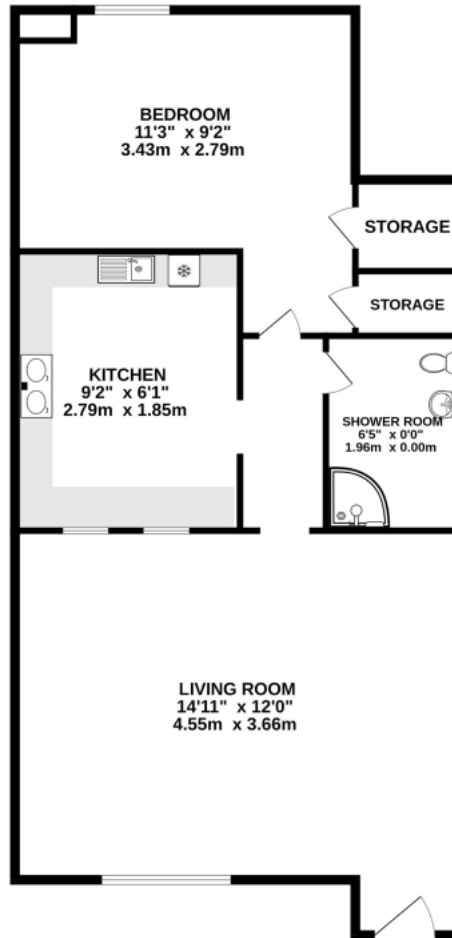

TOTAL FLOOR AREA:127.2 SQ.M

This floorplan is for illustrative purposes only. The measurement and position of each element is approximate and must be viewed as such

Important Information These particulars do not constitute an offer or contract in whole or part. The statements contained herein are made without responsibility on the part of Ashtons or the vendors and they cannot be relied upon as representatives of fact. In respect of floor plans, these are for illustrative purposes only. The measurement and position of each element is approximate and must be viewed as such. Intending purchasers should therefore satisfy themselves by inspection or otherwise as to their correctness. The vendors do not make or give, and neither Ashtons nor any person in their employment has any authority to make or give, any representation or warranty whatsoever in relation to this property. We offer a wide range of services through third party providers including solicitors, surveyors, removal firms, mortgage providers and EPC suppliers. We receive additional payments for administering suppliers quoting software and making referrals. You are not under any obligations to use these services and it is your discretion whether you choose to deal with these parties or your own preferred supplier. You should be aware the average payment we received in 2024 equated to £29.76 per referral.