



1 bedroom



1 bathroom



1 reception



EPC Band C

Council Tax Band:
B £1,782.43 (25/26)



A furnished, modern ground floor 1-bedroom apartment with high-spec finish, video entry, and allocated parking.

Description

This modern ground floor apartment offers an entrance hall leading to an open plan kitchen and living/dining area with engineered wood flooring and a spacious balcony. The kitchen is finished to a high standard with Siemens integrated appliances and a contemporary design. A bright double bedroom completes the living space, while a modern bathroom with Hansgrohe and Duravit fittings, complemented by high-end Catalano Vanity units, serves the property. Access to the development includes a video entry system. Externally, the property benefits from a communal rooftop terrace and an allocated parking space.





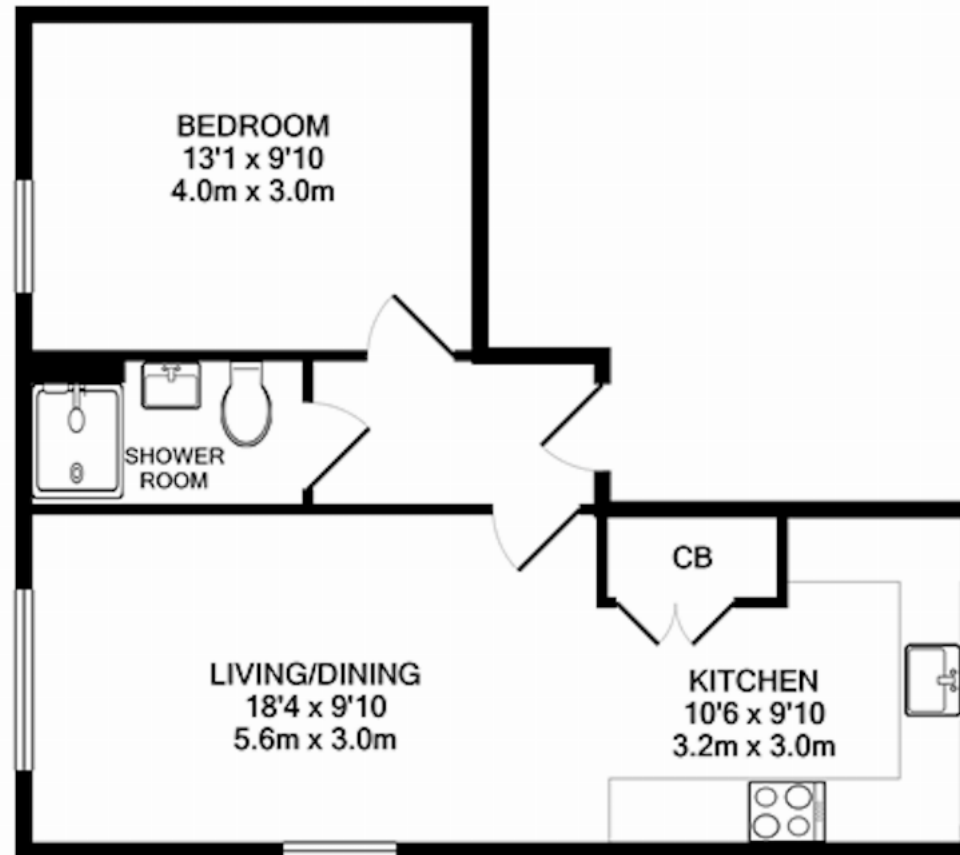

TOTAL APPROX. FLOOR AREA 468 SQ.FT. (43.5 SQ.M.)
Made with Metropix ©2020

Important Information These particulars do not constitute an offer or contract in whole or part. The statements contained herein are made without responsibility on the part of Ashtons or the vendors and they cannot be relied upon as representatives of fact. In respect of floor plans, these are for illustrative purposes only. The measurement and position of each element is approximate and must be viewed as such. Intending purchasers should therefore satisfy themselves by inspection or otherwise as to their correctness. The vendors do not make or give, and neither Ashtons nor any person in their employment has any authority to make or give, any representation or warranty whatsoever in relation to this property. We offer a wide range of services through third party providers including solicitors, surveyors, removal firms, mortgage providers and EPC suppliers. We receive additional payments for administering suppliers quoting software and making referrals. You are not under any obligations to use these services and it is your discretion whether you choose to deal with these parties or your own preferred supplier. You should be aware the average payment we received in 2024 equated to £29.76 per referral.