

 6 Bedrooms

 3 Bathrooms

 5 Receptions

 Private Garden

 Driveway

 EPC Band D

Freehold

Council Tax Band:
H £4,542.04 (2025/26)

Local Authority:
Dacorum Council



Impressive 4,090 sq. ft. 6-bedroom home with mature gardens in picturesque Piccotts End. Gated drive, light accommodation, excellent decor throughout.

Description

In the heart of the picturesque hamlet of Piccotts End, Greenbanks is a superb family home dating from the 1920s, extended and modernised over the years. It's set well back from the road behind driveway gates in attractive grounds. Visitors enter via a solid oak door and large porch leading to a spacious entrance hall. Access from here to main reception rooms includes a large sitting room, corner family room with double aspect, study, and guest cloakroom. The dining room overlooks a Japanese-style garden adjoining the well-appointed kitchen and large utility/boot room. Upstairs are the principal suite with bedroom and large bathroom, four further bedrooms, family bathroom, and laundry room. The sixth bedroom is on the second floor, overlooking the garden and neighbouring orchard. Greenbanks is approached via a long driveway with wrought iron gates, providing ample parking. To the rear is a terraced and lawned garden with mature borders and patio areas for a sunny aspect.

Location

The property is in the Conservation Area of Piccotts End near Hemel Hempstead Old Town, offering quiet living with excellent road and rail links. Close to Berkhamsted, schools, leisure facilities, and more, with easy access to A41 and M1.

Buyers Information: - In compliance with the UK's Anti Money Laundering (AML) regulations, we are required to confirm the identity of all prospective buyers at the point of an offer being accepted and use a third party, Identity Verification System to do so. There is a nominal charge of £48 (per person) including VAT for this service. For more information, please refer to the terms and conditions section of our website.







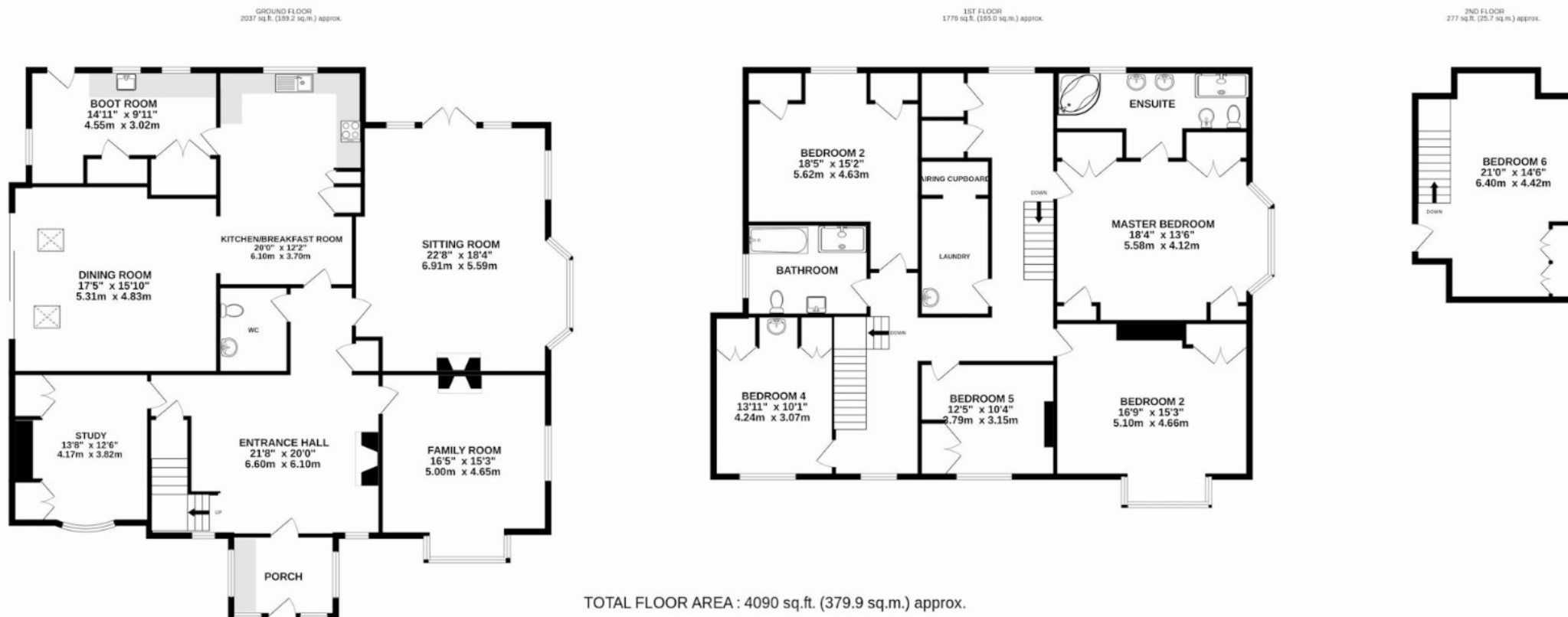

This floorplan is for illustrative purposes only. The measurement and position of each element is approximate and must be viewed as such.

Important Information These particulars do not constitute an offer or contract in whole or part. The statements contained herein are made without responsibility on the part of Ashtons or the vendors and they cannot be relied upon as representatives of fact. In respect of floor plans, these are for illustrative purposes only. The measurement and position of each element is approximate and must be viewed as such. Intending purchasers should therefore satisfy themselves by inspection or otherwise as to their correctness. The vendors do not make or give, and neither Ashtons nor any person in their employment has any authority to make or give, any representation or warranty whatsoever in relation to this property. We offer a wide range of services through third party providers including solicitors, surveyors, removal firms, mortgage providers and EPC suppliers. We receive additional payments for administering suppliers quoting software and making referrals. You are not under any obligations to use these services and it is your discretion whether you choose to deal with these parties or your own preferred supplier. You should be aware the average payment we received in 2024 equated to £29.76 per referral.