

 2 Bedrooms

 1 Bathroom

 1 Reception

 Communal Garden

 Allocated

 EPC Band D

Leasehold (129 years remaining)

Service Charge:
£2,750.00 per annum

Ground Rent:
£458.00 per annum

Council Tax Band:
C £2,138.03 (2026-2027)

Local Authority:
Welwyn Hatfield Borough Council



Well-presented 2-bed top-floor apartment, bright and spacious with no onward chain.

Description

This well-presented apartment is in good condition throughout, making it move-in ready. The accommodation includes two bedrooms, a spacious living room featuring a Juliet balcony with views over well-maintained communal gardens, a fitted kitchen, and a modern bathroom. Additionally, there is loft access. Further benefits include allocated parking and no onward chain.

Location

Merrifield Court is a particularly popular development situated on the southern outskirts of Welwyn Garden City approximately a mile and a half from the town centre's amenities.



In compliance with the UK's Anti Money Laundering (AML) regulations, we are required to confirm the identity of all prospective buyers at the point of an offer being accepted and use a third party, Identity Verification System to do so. There is a nominal charge of £48 (per person) including VAT for this service. For more information, please refer to the terms and conditions section of our website.





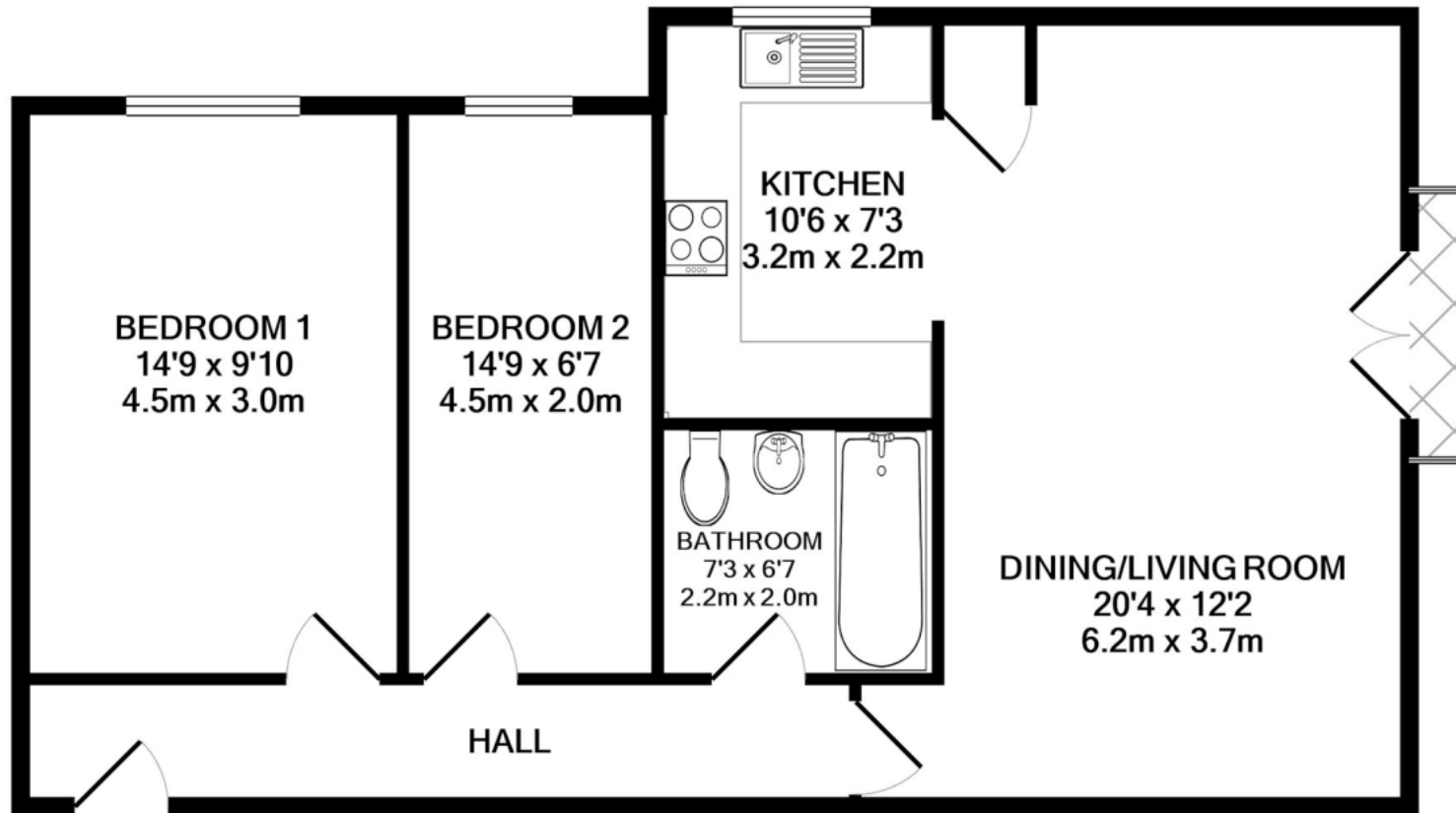

TOTAL APPROX. FLOOR AREA 690 SQ.FT. (64.1 SQ.M.)

Important Information These particulars do not constitute an offer or contract in whole or part. The statements contained herein are made without responsibility on the part of Ashtons or the vendors and they cannot be relied upon as representatives of fact. In respect of floor plans, these are for illustrative purposes only. The measurement and position of each element is approximate and must be viewed as such. Intending purchasers should therefore satisfy themselves by inspection or otherwise as to their correctness. The vendors do not make or give, and neither Ashtons nor any person in their employment has any authority to make or give, any representation or warranty whatsoever in relation to this property. We offer a wide range of services through third party providers including solicitors, surveyors, removal firms, mortgage providers and EPC suppliers. We receive additional payments for administering suppliers quoting software and making referrals. You are not under any obligations to use these services and it is your discretion whether you choose to deal with these parties or your own preferred supplier. You should be aware the average payment we received in 2024 equated to £29.76 per referral.