



1 bedroom



1 bathroom



1 reception



Patio



Allocated



EPC Band C

Leasehold

Council Tax Band:

B £1,782.43 (2025-2026)

Local Authority:

Welwyn Hatfield Borough Council





Beautifully presented 1-bed ground floor apartment in modern development, a stone's throw from the mainline station and town centre amenities.

### Description

This one-bedroom ground floor apartment is beautifully presented and ideal as a first home or investment. It features a stylish fitted kitchen with Quartz worktops and Siemens integrated appliances, including oven, microwave, induction hob, dishwasher, and fridge/freezer. Additional amenities include a utility cupboard, fitted bedroom wardrobes, LED feature lighting, and glass splashbacks for a clean, modern design. The bathroom offers Hansgrohe and Duravit fittings, complemented by Catalano vanity units. Further highlights include engineered oak flooring, a Wi-Fi enabled speaker system, a spacious private patio, and a video entry phone system. The development also includes a communal roof terrace and one allocated parking space. Leasehold: 150 years from 24 June 2019. Service Charge: £1400 pa. Ground Rent: £140 pa.

### Location

Mercury House in Welwyn Garden City blends rural and urban life. Enjoy shops like John Lewis/Cote, independents, leisure at Stanborough Park, Gosling sports center, and nearby golf courses. Train station 5 mins away, for Kings Cross and Moorgate.

Buyers Information: - In compliance with the UK's Anti Money Laundering (AML) regulations, we are required to confirm the identity of all prospective buyers at the point of an offer being accepted and use a third party, Identity Verification System to do so. There is a nominal charge of £48 (per person) including VAT for this service. For more information, please refer to the terms and conditions section of our website.









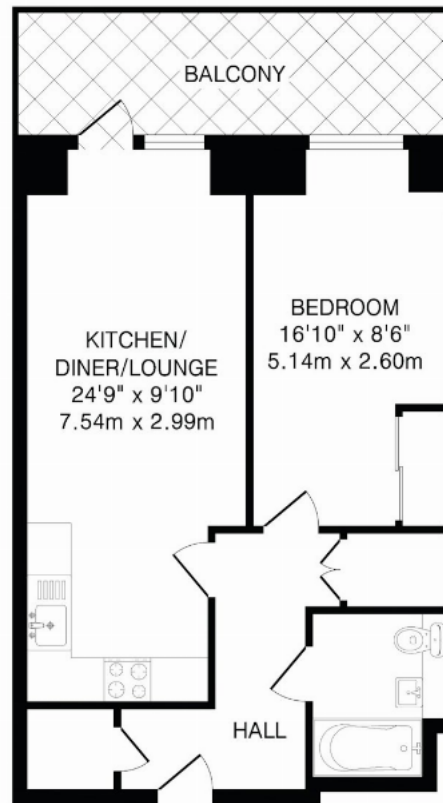

TOTAL FLOOR AREA: 529 sq.ft.(49.1 sq.m)approx.  
 This floorplan is for illustration purposes only. The measurements  
 and position of each element are approximate and must be viewed  
 as such.

**Important Information** These particulars do not constitute an offer or contract in whole or part. The statements contained herein are made without responsibility on the part of Ashtons or the vendors and they cannot be relied upon as representatives of fact. In respect of floor plans, these are for illustrative purposes only. The measurement and position of each element is approximate and must be viewed as such. Intending purchasers should therefore satisfy themselves by inspection or otherwise as to their correctness. The vendors do not make or give, and neither Ashtons nor any person in their employment has any authority to make or give, any representation or warranty whatsoever in relation to this property. We offer a wide range of services through third party providers including solicitors, surveyors, removal firms, mortgage providers and EPC suppliers. We receive additional payments for administering suppliers quoting software and making referrals. You are not under any obligations to use these services and it is your discretion whether you choose to deal with these parties or your own preferred supplier. You should be aware the average payment we received in 2024 equated to £29.76 per referral.