 2 Bedrooms

 2 Bathrooms

 1 Reception

 EPC Band B

Leasehold

Council Tax Band:
D £0.00 ()



Sir John Newsom Way, Welwyn Garden City, Hertfordshire, AL7 4FL
Guide price of £260,000

Description

A well-presented first floor apartment offering spacious accommodation including a good size lounge/dining room with access to the fitted kitchen with integrated appliances, a principal bedroom with en-suite shower room, a good size second bedroom, hallway and spacious family bathroom. Externally, the property benefits from allocated parking and well-kept communal gardens.

Location

Sir John Newsom Way is just over a mile from the town centre of Welwyn Garden City, with a mainline train to London (28 mins), shopping, and leisure facilities. Part of a modern, private development, it is within excellent school catchment.



Buyers Information: - In compliance with the UK's Anti Money Laundering (AML) regulations, we are required to confirm the identity of all prospective buyers at the point of an offer being accepted and use a third party, Identity Verification System to do so. There is a nominal charge of £48 (per person) including VAT for this service. For more information, please refer to the terms and conditions section of our website.





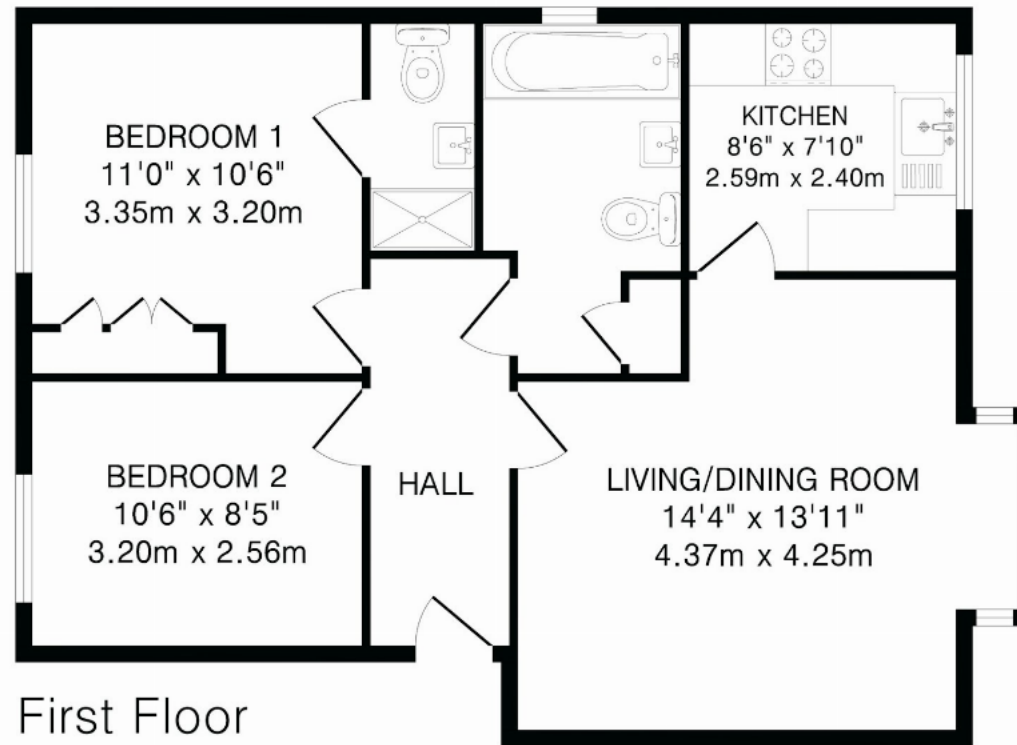

TOTAL FLOOR AREA: 631 sq.ft.(58.5 sq.m)approx.
 This floorplan is for illustration purposes only. The measurements and position of each element are approximate and must be viewed as such.

Important Information These particulars do not constitute an offer or contract in whole or part. The statements contained herein are made without responsibility on the part of Ashtons or the vendors and they cannot be relied upon as representatives of fact. In respect of floor plans, these are for illustrative purposes only. The measurement and position of each element is approximate and must be viewed as such. Intending purchasers should therefore satisfy themselves by inspection or otherwise as to their correctness. The vendors do not make or give, and neither Ashtons nor any person in their employment has any authority to make or give, any representation or warranty whatsoever in relation to this property. We offer a wide range of services through third party providers including solicitors, surveyors, removal firms, mortgage providers and EPC suppliers. We receive additional payments for administering suppliers quoting software and making referrals. You are not under any obligations to use these services and it is your discretion whether you choose to deal with these parties or your own preferred supplier. You should be aware the average payment we received in 2024 equated to £29.76 per referral.