

-  1 Bedroom
-  1 Bathroom
-  1 Reception
-  EPC Band C

Council Tax Band:
B £1,870.78 (2026/ 2027)



Town Centre, Hatfield, Hertfordshire, AL10 0JW
£1,150 PCM

Luxurious large 1-bedroom top floor apartment with spacious, contemporary living, excellent views and convenience.

Description

This modern apartment perfectly blends bright, spacious accommodation with high ceilings and wide doors, in an ideal location with pleasant views. Off the large entrance hall is a generous bedroom with fitted wardrobe, a stylish bathroom with three-piece suite, and a well-proportioned living area featuring dual aspect windows and a semi-open plan kitchen with fully integrated appliances. The French doors open to a good-sized balcony, adding even more light to the bright living space. Additional benefits include a video entrance phone, well-maintained communal areas, lift service, bicycle storage, and allocated parking. Post Code: AL10 0JW Council Tax: Band B - £1,870.78 April 2026 - March 2027

Location

This apartment offers easy access to the A1(M) and A414, ideal for commuters with Hatfield station 15 mins walk, reaching Kings Cross in 24 mins. Nearby amenities include a gym, swimming pool, large supermarket, and a parade of shops.





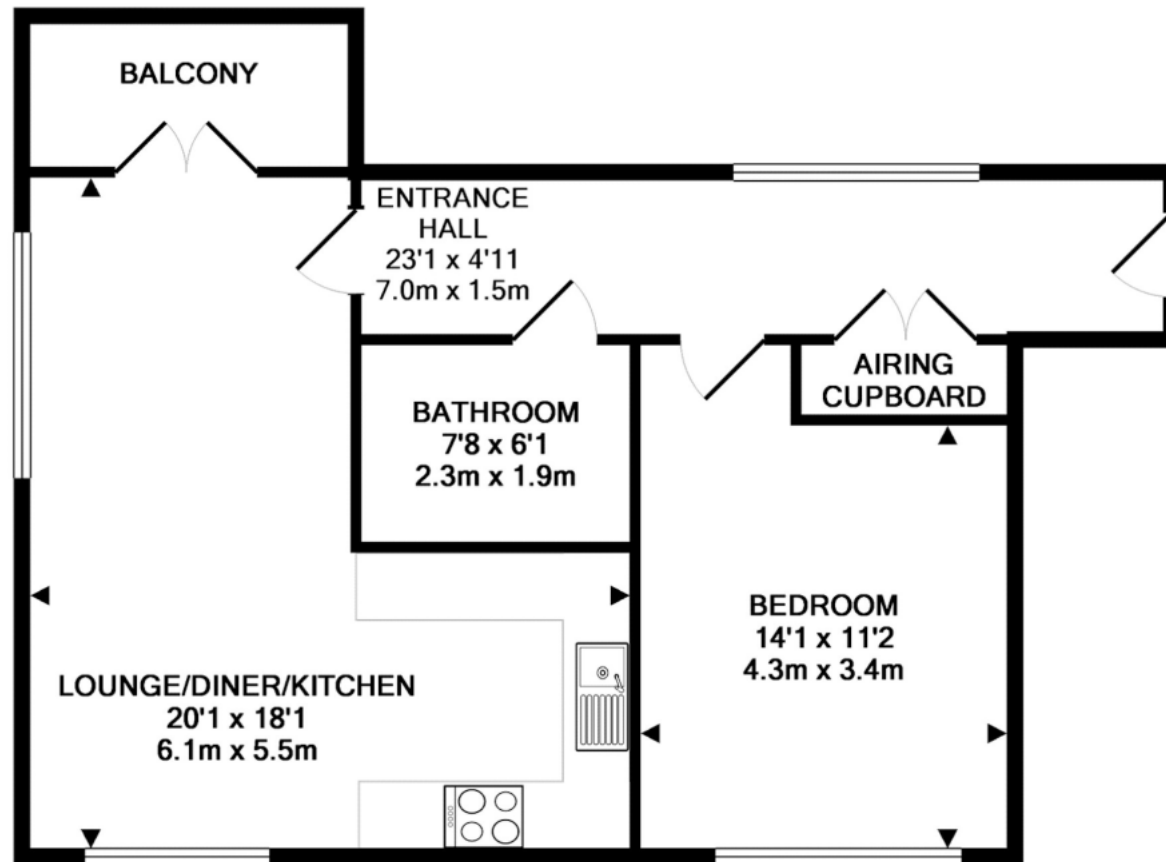

TOTAL APPROX. FLOOR AREA 654 SQ.FT. (60.8 SQ.M.)

Important Information These particulars do not constitute an offer or contract in whole or part. The statements contained herein are made without responsibility on the part of Ashtons or the vendors and they cannot be relied upon as representatives of fact. In respect of floor plans, these are for illustrative purposes only. The measurement and position of each element is approximate and must be viewed as such. Intending purchasers should therefore satisfy themselves by inspection or otherwise as to their correctness. The vendors do not make or give, and neither Ashtons nor any person in their employment has any authority to make or give, any representation or warranty whatsoever in relation to this property. We offer a wide range of services through third party providers including solicitors, surveyors, removal firms, mortgage providers and EPC suppliers. We receive additional payments for administering suppliers quoting software and making referrals. You are not under any obligations to use these services and it is your discretion whether you choose to deal with these parties or your own preferred supplier. You should be aware the average payment we received in 2024 equated to £29.76 per referral.