 2 Bedrooms

 1 Bathroom

 1 Reception

 Private Garden

 Garage

Freehold

Council Tax Band:
D £2,476.90 (2026-2027)

Local Authority:
North Hertfordshire District Council



 **ashtons**
for life's great moves

Old School Close, Codicote, Hitchin, SG4 8YJ
Offers in excess of £325,000

Stunning two-bedroom cottage from a 1920's school conversion, offered to the market chain free!

Description

Nestled within the peaceful enclave of Old School Close, this enchanting circa 1920 school house conversion perfectly marries vintage character with modern living. Offering a mews-style home moments from Codicote High Street, this quaint two-bedroom property is brimming with charm. The accommodation opens into an inviting entrance hall with a staircase rising to the first floor. At the heart of the home is a bright lounge that flows into a beautifully appointed modern kitchen, creating a semi-open plan layout. Upstairs, there are two comfortable bedrooms served by a three-piece bathroom suite, featuring a classic 'P-shaped' shower bath. The outdoor spaces are a true highlight, offering a private sanctuary near the village centre. To the rear is a beautiful, walled courtyard garden laid to low-maintenance paving, ideal for alfresco dining with gated access to rear parking/garage area. A neat front garden faces into a picturesque mews courtyard, while a private garage provides excellent storage or parking.

Location

The converted school is part of a renowned modern development, close to the village high street with excellent shopping, dining and pubs. A well-regarded JMI school is nearby. Knebworth station is close, with easy access to the A1(M).



In compliance with the UK's Anti Money Laundering (AML) regulations, we are required to confirm the identity of all prospective buyers at the point of an offer being accepted and use a third party, Identity Verification System to do so. There is a nominal charge of £48 (per person) including VAT for this service. For more information, please refer to the terms and conditions section of our website.







Ground Floor
290 sq.ft.(26.9 sq.m)approx.

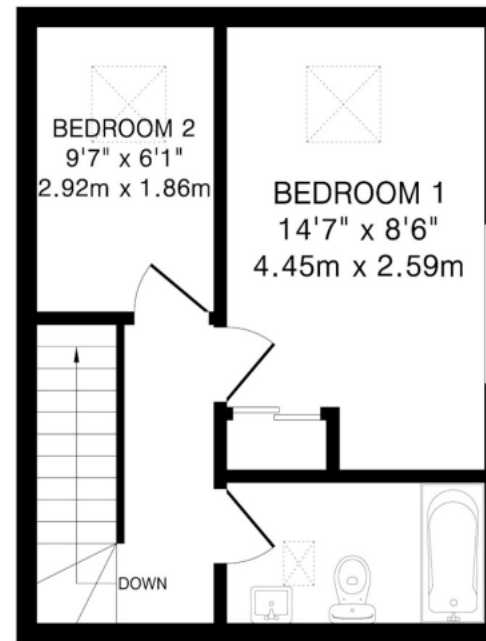

First Floor
290 sq.ft.(26.9 sq.m)approx.

TOTAL FLOOR AREA: 580 sq.ft.(53.8 sq.m)approx.

This floorplan is for illustration purposes only. The measurements and position of each element are approximate and must be viewed as such.

Important Information These particulars do not constitute an offer or contract in whole or part. The statements contained herein are made without responsibility on the part of Ashtons or the vendors and they cannot be relied upon as representatives of fact. In respect of floor plans, these are for illustrative purposes only. The measurement and position of each element is approximate and must be viewed as such. Intending purchasers should therefore satisfy themselves by inspection or otherwise as to their correctness. The vendors do not make or give, and neither Ashtons nor any person in their employment has any authority to make or give, any representation or warranty whatsoever in relation to this property. We offer a wide range of services through third party providers including solicitors, surveyors, removal firms, mortgage providers and EPC suppliers. We receive additional payments for administering suppliers quoting software and making referrals. You are not under any obligations to use these services and it is your discretion whether you choose to deal with these parties or your own preferred supplier. You should be aware the average payment we received in 2024 equated to £29.76 per referral.