

 6 Bedrooms

 6 Bathrooms

 5 Receptions

 Private Garden

 Driveway

 EPC Band E



Freehold

Council Tax Band:
H £4,983.58 (2026-2027)

Local Authority:
East Hertfordshire District Council

 **ashtons**
for life's great moves

Mangrove Lane, Hertford, Hertfordshire, SG13 8QG
Guide price of £2,100,000

Elegant farmhouse with cottage, 6 beds, open-plan living, mature gardens, meadow, ample parking, versatile for modern family living.

Description

Swallow Grove Farmhouse, with The Mews Cottage, offers a stunning country home with character and versatility. The property includes six bedrooms and elegant, flexible reception spaces for modern family life. The detached cottage is ideal for guests, multi-generational living, or potential income. The main house boasts charming red brick, rendered and timber-framed elevations, seamlessly blending period character and contemporary design. The heart is an impressive open-plan kitchen, dining and sitting area, featuring bi-fold doors opening to the gardens. The kitchen includes classic shaker-style cabinetry, a central island, an Aga, and high-spec appliances. A utility room, shower room, and walk-in pantry adjoin the kitchen. The ground floor also has two reception rooms with garden views and iron fireplaces. Upstairs, find five bedrooms, a principal suite with dressing room and en-suite, and a stylish family bathroom. A cinema room provides additional living space. The Mews Cottage offers a sitting room, sunroom, kitchen, shower room, double bedroom, and shower room. Accessed via electric gates, the property features a gravel driveway, ample parking, expansive gardens, patios, and a pergola with wisteria, leading to a large meadow, completing this idyllic setting.

Location

Swallow Grove Farmhouse enjoys a highly sought-after rural setting along Mangrove Lane, just one mile from the heart of Hertford, the historic and vibrant county town of Hertfordshire. Surrounded by open countryside yet



In compliance with the UK's Anti Money Laundering (AML) regulations, we are required to confirm the identity of all prospective buyers at the point of an offer being accepted and use a third party, Identity Verification System to do so. There is a nominal charge of £48 (per person) including VAT for this service. For more information, please refer to the terms and conditions section of our website.





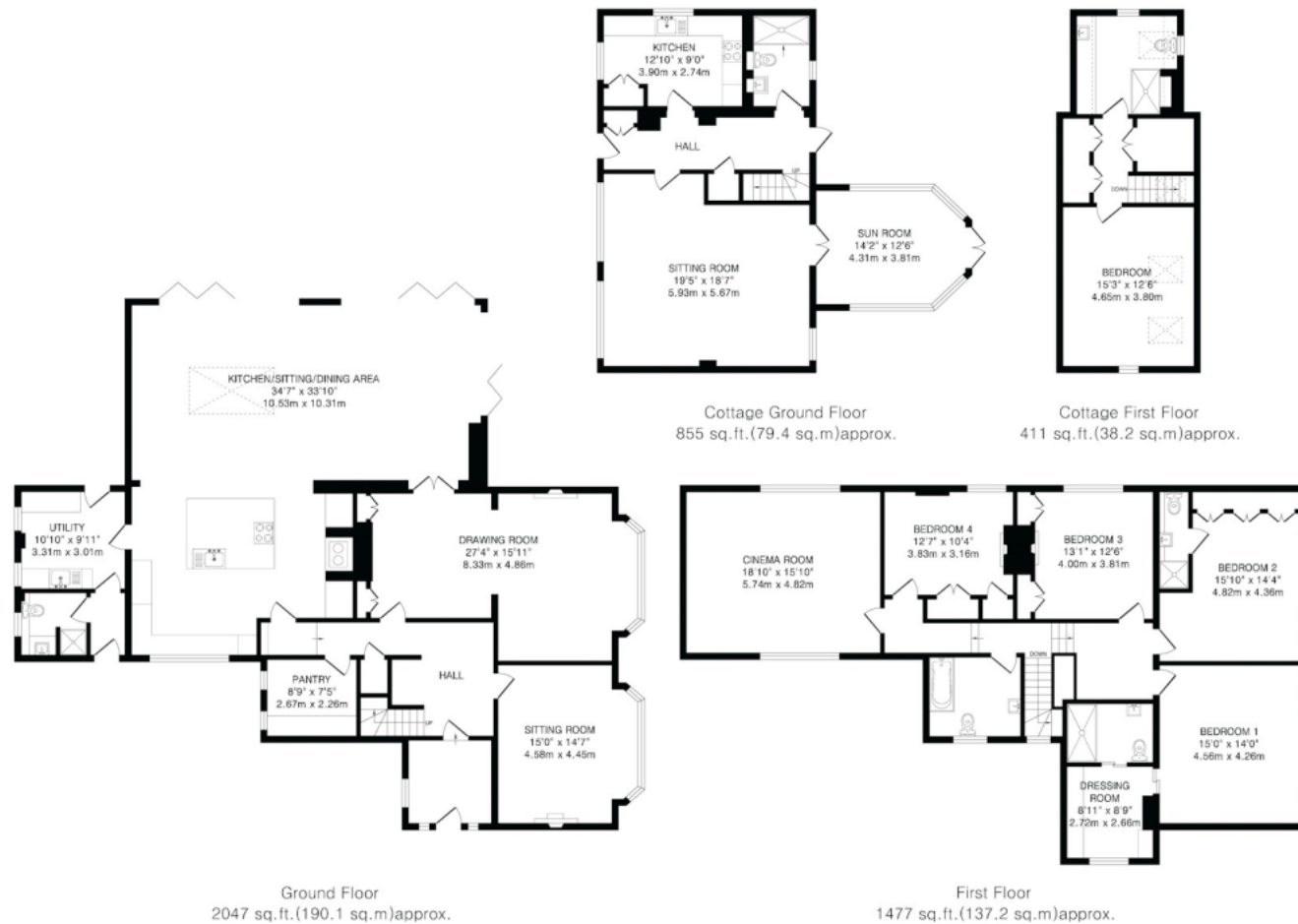

TOTAL FLOOR AREA: 4790 sq.ft.(444.9 sq.m)approx.

This floorplan is for illustration purposes only. The measurements and position of each element are approximate and must be viewed as such.

Important Information These particulars do not constitute an offer or contract in whole or part. The statements contained herein are made without responsibility on the part of Ashtons or the vendors and they cannot be relied upon as representatives of fact. In respect of floor plans, these are for illustrative purposes only. The measurement and position of each element is approximate and must be viewed as such. Intending purchasers should therefore satisfy themselves by inspection or otherwise as to their correctness. The vendors do not make or give, and neither Ashtons nor any person in their employment has any authority to make or give, any representation or warranty whatsoever in relation to this property. We offer a wide range of services through third party providers including solicitors, surveyors, removal firms, mortgage providers and EPC suppliers. We receive additional payments for administering suppliers quoting software and making referrals. You are not under any obligations to use these services and it is your discretion whether you choose to deal with these parties or your own preferred supplier. You should be aware the average payment we received in 2024 equated to £29.76 per referral.