



1 Bedroom



1 Bathroom



1 Reception



EPC Band C



Refurbished 1-bed first floor maisonette with driveway & rear garden, available immediately.

Description

This beautifully renovated maisonette boasts a spacious lounge and dining area, complemented by a well-appointed kitchen. The bedroom offers ample space and includes fitted wardrobes. The bathroom is a luxurious retreat, featuring a shower over the bathtub. Outside, the property provides the convenience of driveway parking and a private rear garden, enhancing its appeal. Post Code: AL7 2HY Council Tax: Band B - £1,621.90 (April 2023 - March 2024)

Location

Yew Grove, located in Panshanger, Welwyn Garden City, is within walking distance to local amenities like Morrisons supermarket. Panshanger offers easy access to the town centre and mainline railway station, with a 28-minute journey to Kings Cross.





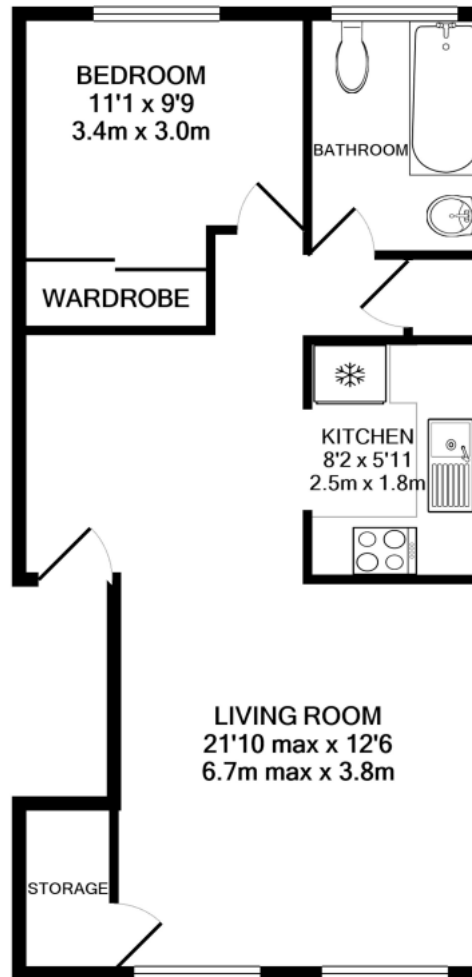

TOTAL APPROX. FLOOR AREA 487 SQ.FT. (45.2 SQ.M.)

This floor plan is for illustrative purposes only.
The measurement and position of each element is approximate and must be viewed as such.

Important Information These particulars do not constitute an offer or contract in whole or part. The statements contained herein are made without responsibility on the part of Ashtons or the vendors and they cannot be relied upon as representatives of fact. In respect of floor plans, these are for illustrative purposes only. The measurement and position of each element is approximate and must be viewed as such. Intending purchasers should therefore satisfy themselves by inspection or otherwise as to their correctness. The vendors do not make or give, and neither Ashtons nor any person in their employment has any authority to make or give, any representation or warranty whatsoever in relation to this property. We offer a wide range of services through third party providers including solicitors, surveyors, removal firms, mortgage providers and EPC suppliers. We receive additional payments for administering suppliers quoting software and making referrals. You are not under any obligations to use these services and it is your discretion whether you choose to deal with these parties or your own preferred supplier. You should be aware the average payment we received in 2024 equated to £29.76 per referral.