



1 bedroom



1 bathroom



1 reception



EPC Band D

Leasehold

Council Tax Band:
C £2,097.02 (2025/26)

Local Authority:
St Albans Council



Spacious 1 bed first-floor retirement apartment, newly updated to a high standard near Redbourn High Street and local amenities.

Description

This beautifully presented first floor flat has been updated throughout, with recently refitted kitchen and shower room. It offers an attractive outlook over pretty communal gardens. Available to 'Over 55's', it is ideally located a short walk from High Street amenities. The flat has its own private entrance with stairs leading to a small landing. Accommodation includes a generous living/dining room opening into a refitted kitchen with stylish units and integrated appliances. A good-sized double bedroom with built-in wardrobe and spacious refitted shower room complete the accommodation. There are two large storage cupboards and loft access. The development features communal attributes such as residents parking, a communal living room for social gatherings, a laundry room and an on-site Residents Manager. A 24-hour Careline is also available. Lease: 125 Years from 1/9/1988. Service Charge: £3,767 pa.

Location

Located off High Street in award-winning Redbourn, this property offers excellent amenities: Doctors surgery, Dentist, Hair Salon, Chemist, and Co-op. Close to St Albans and Harpenden, with fast rail links to London.



Buyers Information - In compliance with the UK's Anti Money Laundering (AML) regulations, we are required to confirm the identity of all prospective buyers at the point of an offer being accepted and use a third party, Identity Verification System to do so. There is a nominal charge of £48 (per person) including VAT for this service. For more information, please refer to the terms and conditions section of our website





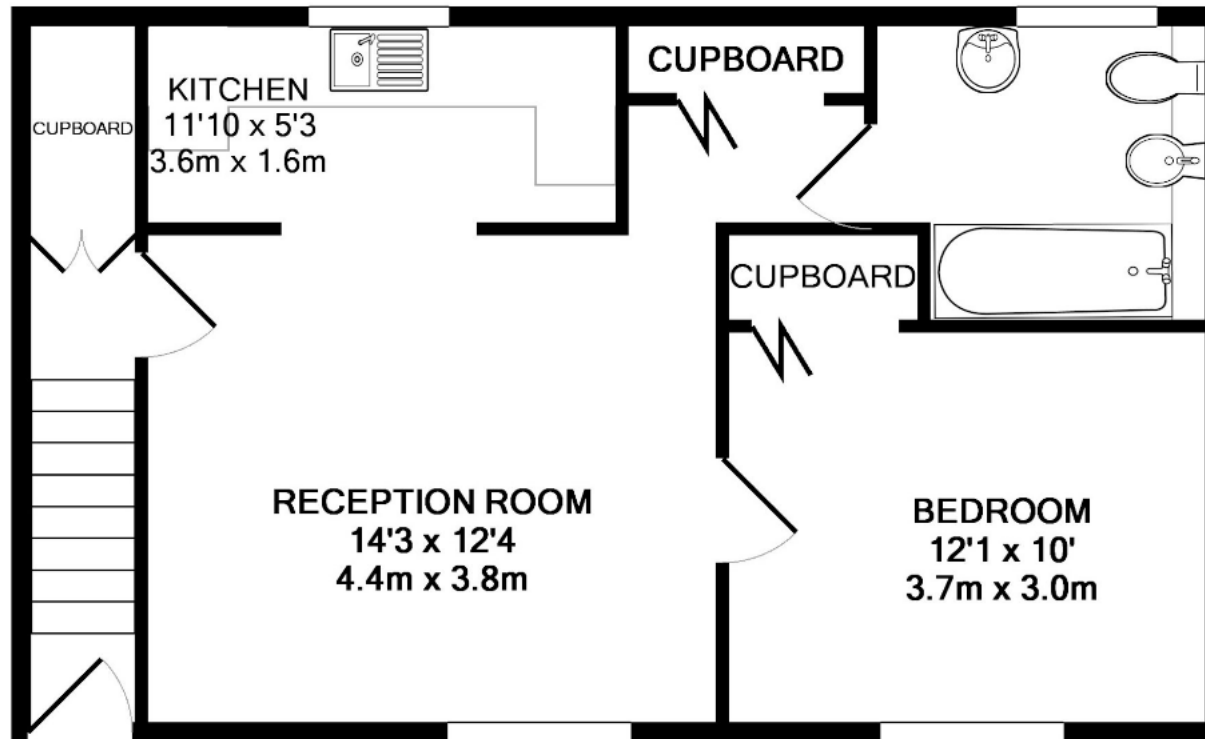

TOTAL APPROX. FLOOR AREA 516 SQ.FT. (47.9 SQ.M.)

This floor plan is for illustrative purposes only. The measurement and position of each element is approximate and must be viewed as such.

Important Information These particulars do not constitute an offer or contract in whole or part. The statements contained herein are made without responsibility on the part of Ashtons or the vendors and they cannot be relied upon as representatives of fact. In respect of floor plans, these are for illustrative purposes only. The measurement and position of each element is approximate and must be viewed as such. Intending purchasers should therefore satisfy themselves by inspection or otherwise as to their correctness. The vendors do not make or give, and neither Ashtons nor any person in their employment has any authority to make or give, any representation or warranty whatsoever in relation to this property. We offer a wide range of services through third party providers including solicitors, surveyors, removal firms, mortgage providers and EPC suppliers. We receive additional payments for administering suppliers quoting software and making referrals. You are not under any obligations to use these services and it is your discretion whether you choose to deal with these parties or your own preferred supplier. You should be aware the average payment we received in 2024 equated to £29.76 per referral.