 3 Bedrooms

 1 Bathroom

 1 Reception

 Private Garden

 Garage

Freehold

Council Tax Band:  
C £2,198.58 (2026/27)

Local Authority:  
St Albans Council

 **ashtons**  
for life's great moves

Stephens Way, Redbourn, AL3 7EA  
Guide price of £450,000

Well-presented 3-bedroom village home in a peaceful cul-de-sac near the common.

### Description

This excellent three-bedroom village home offers spacious accommodation and a private garden. A driveway provides off-street parking, and there's a single garage at the front. The entrance leads into an attractive hallway accessing a large kitchen/diner fitted with a modern range of units and space for an oven, washing machine, and fridge/freezer. An attractive living room is positioned at the rear with access to the garden. Off the hallway, a cloakroom with WC and hand basin completes the downstairs accommodation. Upstairs are three good-sized bedrooms served by a modern family bathroom with a white three-piece suite. Outside, the attractive rear garden has been well maintained, mainly laid to lawn with various seating areas and borders with mature planting.

### Location

Situated near the village Common in Redbourn, Hertfordshire, this charming village offers great amenities, a well-regarded school, and convenient access to the M1 J9, M25, Luton Airport, and efficient rail links in Harpenden and St Albans.



Buyers Information: - In compliance with the UK's Anti Money Laundering (AML) regulations, we are required to confirm the identity of all prospective buyers at the point of an offer being accepted and use a third party, Identity Verification System to do so. There is a nominal charge of £48 (per person) including VAT for this service. For more information, please refer to the terms and conditions section of our website.





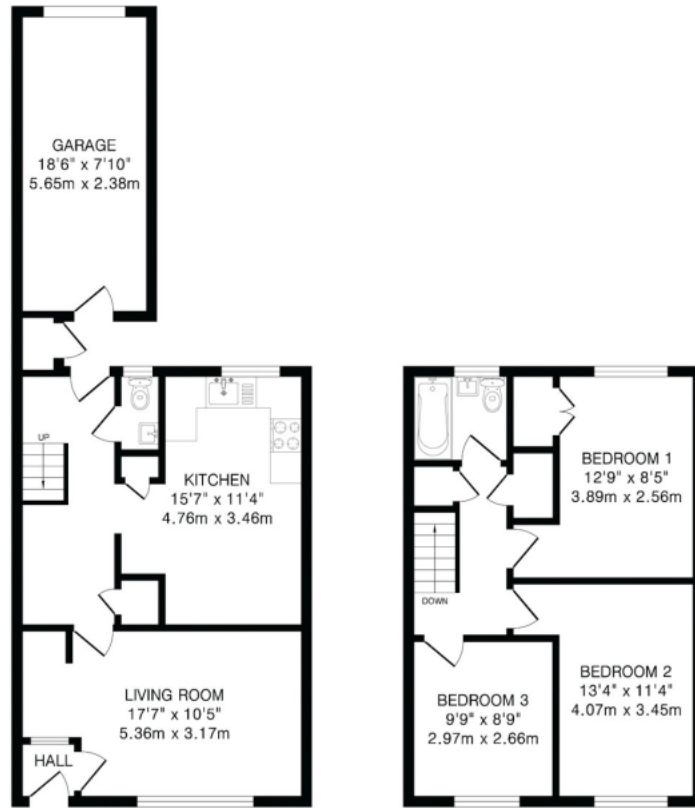

Ground Floor  
618 sq.ft.(57.4 sq.m)approx.

First Floor  
465 sq.ft.(43.2 sq.m)approx.

TOTAL FLOOR AREA: 1083 sq.ft.(100.6 sq.m)approx.  
 This floorplan is for illustration purposes only. The measurements and position of each element are approximate and must be viewed as such.

**Important Information** These particulars do not constitute an offer or contract in whole or part. The statements contained herein are made without responsibility on the part of Ashtons or the vendors and they cannot be relied upon as representatives of fact. In respect of floor plans, these are for illustrative purposes only. The measurement and position of each element is approximate and must be viewed as such. Intending purchasers should therefore satisfy themselves by inspection or otherwise as to their correctness. The vendors do not make or give, and neither Ashtons nor any person in their employment has any authority to make or give, any representation or warranty whatsoever in relation to this property. We offer a wide range of services through third party providers including solicitors, surveyors, removal firms, mortgage providers and EPC suppliers. We receive additional payments for administering suppliers quoting software and making referrals. You are not under any obligations to use these services and it is your discretion whether you choose to deal with these parties or your own preferred supplier. You should be aware the average payment we received in 2024 equated to £29.76 per referral.