 2 Bedrooms

 2 Bathrooms

 1 Reception

 EPC Band C

Council Tax Band:  
C £0.00 ()



Charming top floor penthouse apartment with vaulted ceilings, panoramic views over Harpenden Common, and allocated parking.

### Description

This light and spacious apartment offers stylish and modern living in a convenient location. The bright and airy reception room and open plan kitchen have double height ceilings and a kitchen island perfect for cooking and entertaining. There are two well-proportioned bedrooms, with the principal offering an ensuite shower room. There is a further family bathroom. The apartment has been recently repainted throughout and has new windows installed. Outside, there are well-kept communal gardens and ample off-street parking to the rear.

### Location

Kings Court, a modern luxury apartment development, is centrally located in Harpenden near Southdown's shops and a 10-minute walk to the high street and station. This penthouse apartment overlooks Harpenden Common and includes allocated parking.







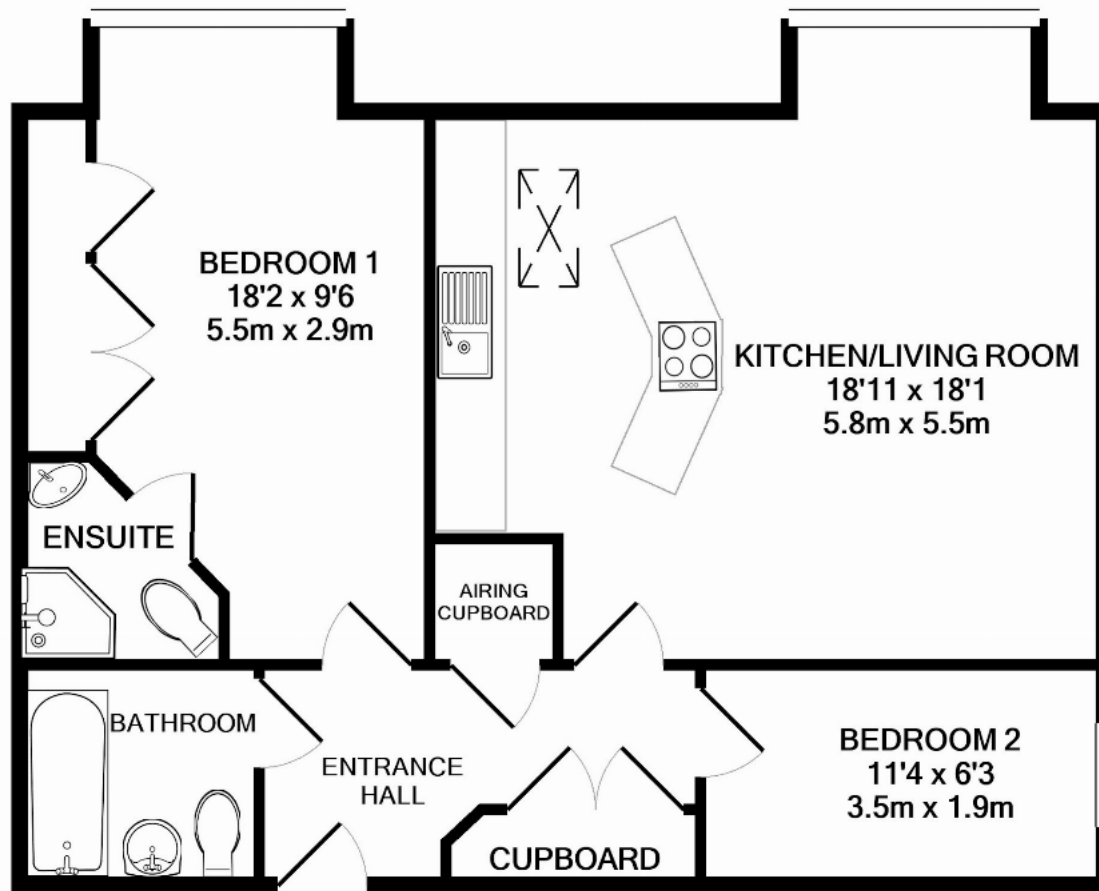

TOTAL APPROX. FLOOR AREA 700 SQ.FT. (65.0 SQ.M.)

This floorplan is for illustration purposes only. The measurements and position of each element are approximate and must be viewed as such.

**Important Information** These particulars do not constitute an offer or contract in whole or part. The statements contained herein are made without responsibility on the part of Ashtons or the vendors and they cannot be relied upon as representatives of fact. In respect of floor plans, these are for illustrative purposes only. The measurement and position of each element is approximate and must be viewed as such. Intending purchasers should therefore satisfy themselves by inspection or otherwise as to their correctness. The vendors do not make or give, and neither Ashtons nor any person in their employment has any authority to make or give, any representation or warranty whatsoever in relation to this property. We offer a wide range of services through third party providers including solicitors, surveyors, removal firms, mortgage providers and EPC suppliers. We receive additional payments for administering suppliers quoting software and making referrals. You are not under any obligations to use these services and it is your discretion whether you choose to deal with these parties or your own preferred supplier. You should be aware the average payment we received in 2024 equated to £29.76 per referral.