

-  1 Bedroom
-  1 Bathroom
-  1 Reception
-  EPC Band C

Council Tax Band:
C £2,217.39 (2026/2027)



Bright, spacious 1 double bed second-floor apartment, ample parking, close to Radlett Station.

Description

A well-proportioned one double bedroom apartment located on the second floor of this modern building, within easy reach of Radlett High Street and the mainline station. Features include an entrance hall with two useful storage cupboards, a living room with laminate flooring and bay window overlooking woodland, a modern fitted kitchen, a large double bedroom with laminate floor, bay window, and wardrobes, and a modern white bathroom suite with fully tiled walls and a shower. Externally, there are communal gardens surrounding the property and ample on-site private residents parking.

Location

Bridge Court is located circa 0.5 miles of Radlett High Street and the Mainline Thameslink Station. There is also quick and easy access to the local Motorway network to include the M1, M25, A1, A41 and A5.





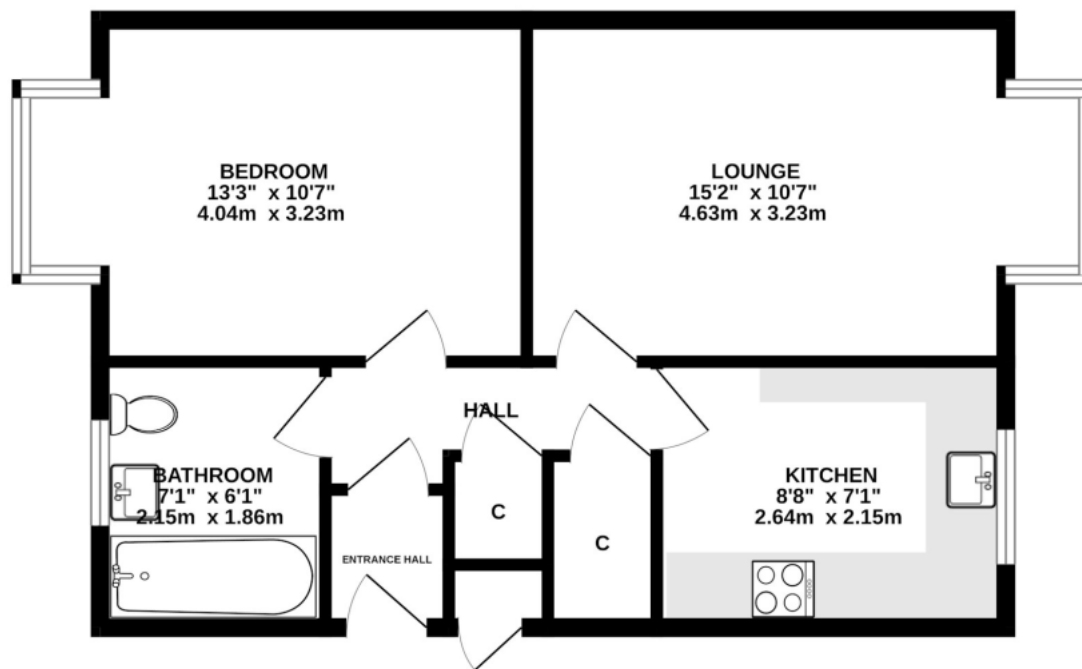

TOTAL FLOOR AREA : 449 sq.ft. (41.7 sq.m.) approx.

This floor plan is for illustrative purposes only. The measurement and position of each element is approximate and must be viewed as such

Important Information These particulars do not constitute an offer or contract in whole or part. The statements contained herein are made without responsibility on the part of Ashtons or the vendors and they cannot be relied upon as representatives of fact. In respect of floor plans, these are for illustrative purposes only. The measurement and position of each element is approximate and must be viewed as such. Intending purchasers should therefore satisfy themselves by inspection or otherwise as to their correctness. The vendors do not make or give, and neither Ashtons nor any person in their employment has any authority to make or give, any representation or warranty whatsoever in relation to this property. We offer a wide range of services through third party providers including solicitors, surveyors, removal firms, mortgage providers and EPC suppliers. We receive additional payments for administering suppliers quoting software and making referrals. You are not under any obligations to use these services and it is your discretion whether you choose to deal with these parties or your own preferred supplier. You should be aware the average payment we received in 2024 equated to £29.76 per referral.