



2 Bedrooms



1 Bathroom



1 Reception



EPC Band C

New two double bedroom semi-detached bungalow with high-quality finish.

Description

This stunning new build two double bedroom semi-detached bungalow offers a stylish and contemporary finish throughout. Upon entering, the property is flooded with natural light and boasts a high-quality finish. Features include marble tiled floors, underfloor heating, a beautifully fitted semi-open plan kitchen with integrated appliances, a lovely white bathroom suite with a good shower, and a large master bedroom with fitted wardrobes. There is a further double bedroom, which can serve as a home office/study or extra living room, and a light, bright open plan living/dining room. Additionally, there is a large storage cupboard with overhead storage.

Location

Located at Green Lane and Francis Avenue in 'New Greens', St Albans, this property is near local amenities like Batchwood sports centre and esteemed schools such as STAGS and Garden Fields, making it a popular choice.





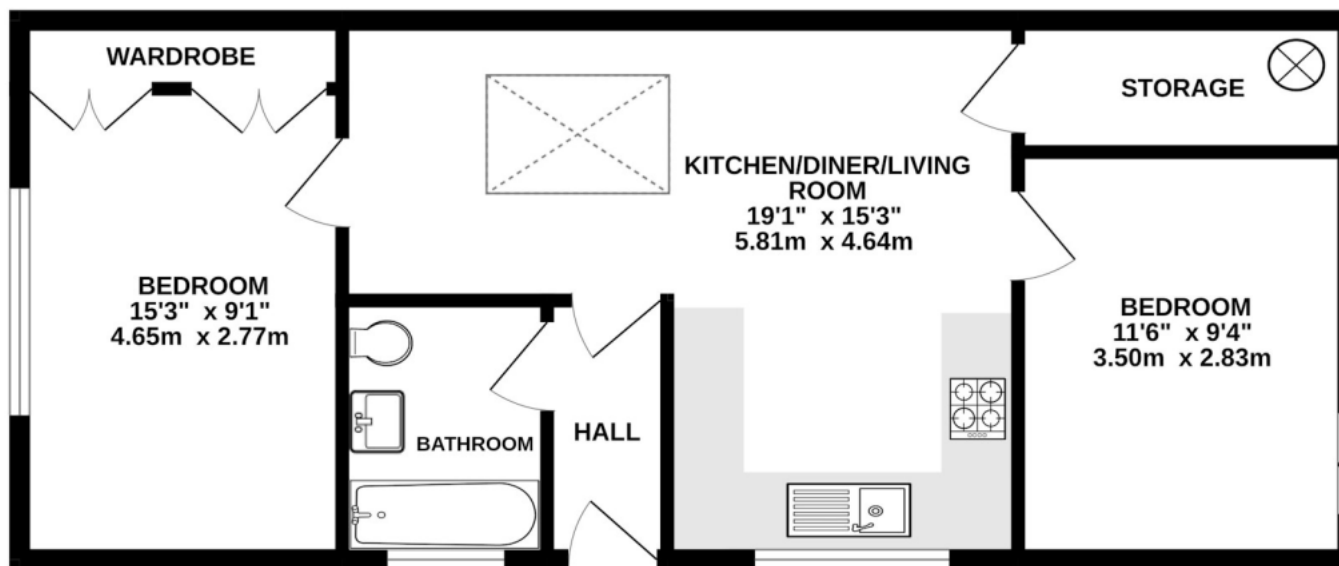

TOTAL FLOOR AREA : 570 sq.ft. (52.9 sq.m.) approx.

This floor plan is for illustrative purposes only. The measurement and position of each element is approximate and must be viewed as such

Important Information These particulars do not constitute an offer or contract in whole or part. The statements contained herein are made without responsibility on the part of Ashtons or the vendors and they cannot be relied upon as representatives of fact. In respect of floor plans, these are for illustrative purposes only. The measurement and position of each element is approximate and must be viewed as such. Intending purchasers should therefore satisfy themselves by inspection or otherwise as to their correctness. The vendors do not make or give, and neither Ashtons nor any person in their employment has any authority to make or give, any representation or warranty whatsoever in relation to this property. We offer a wide range of services through third party providers including solicitors, surveyors, removal firms, mortgage providers and EPC suppliers. We receive additional payments for administering suppliers quoting software and making referrals. You are not under any obligations to use these services and it is your discretion whether you choose to deal with these parties or your own preferred supplier. You should be aware the average payment we received in 2024 equated to £29.76 per referral.