



3 bedrooms



2 bathrooms



4 receptions



EPC Band E

Freehold

Council Tax Band:
F £0.00 ()



Beautifully refurbished 3-bed detached home near top schools, St Albans station, and City centre. South-west plot with extension potential (subject to consent).

Description

This rarely available property is ideally located within walking distance of highly regarded local schools and has been beautifully renovated by the current owners. The spacious accommodation is arranged over two floors, providing a well-balanced layout for modern family living. On the ground floor, there's a welcoming entrance hall, a bright living room, and a separate dining room. The contemporary kitchen with bespoke cabinetry and modern integrated appliances, along with the adjoining conservatory, creates a light-filled area perfect for relaxation or entertaining. Upstairs, there are three generously sized bedrooms and a stylishly appointed family bathroom. Externally, the property has a driveway for ample off-street parking and a covered carport. The mature garden, over 150ft, offers a private outdoor space. A self-contained annex in the garden includes an open-plan living area with a kitchenette, a bedroom, a storeroom, and a shower room. Council Tax: Band F £3,112.94 (2024/2025).

Location

Located on a prime St Albans road with easy City centre and Quadrant shopping access. Walking distance to top schools; in the catchment for Sandringham, STAGS, and Verulam.



Buyers Information: - In compliance with the UK's Anti Money Laundering (AML) regulations, we are required to confirm the identity of all prospective buyers at the point of an offer being accepted and use a third party, Identity Verification System to do so. There is a nominal charge of £48 (per person) including VAT for this service. For more information, please refer to the terms and conditions section of our website.





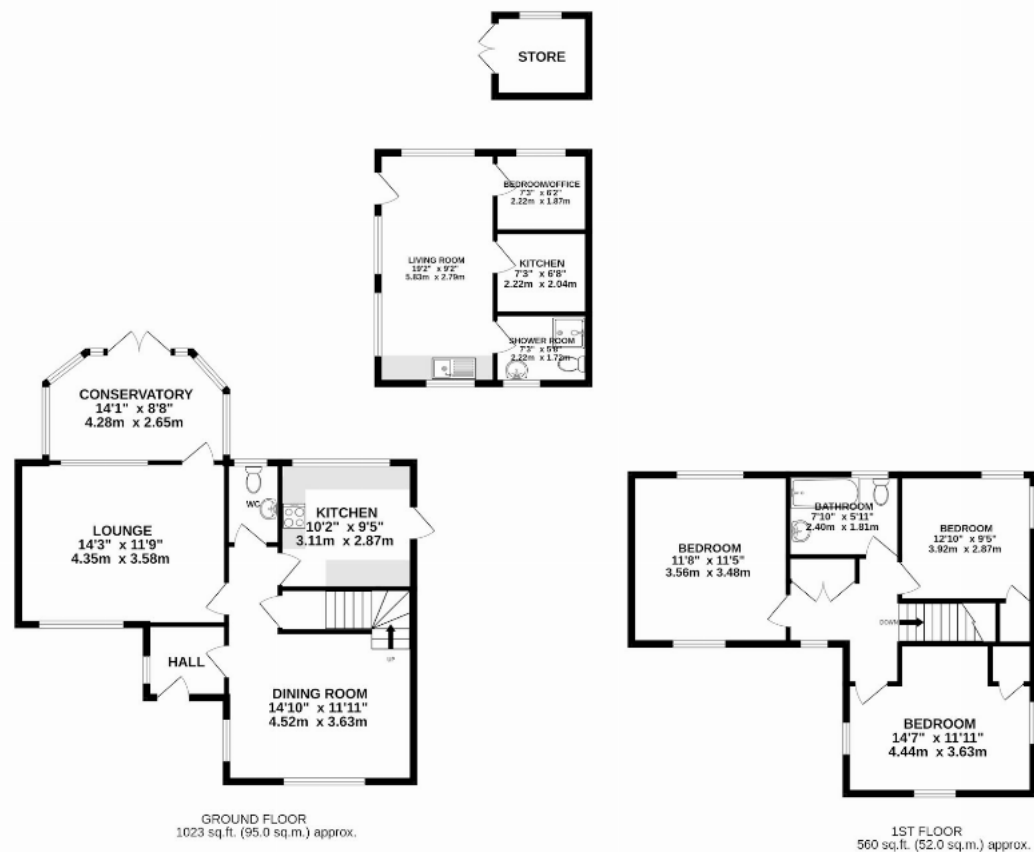

Important Information These particulars do not constitute an offer or contract in whole or part. The statements contained herein are made without responsibility on the part of Ashtons or the vendors and they cannot be relied upon as representatives of fact. In respect of floor plans, these are for illustrative purposes only. The measurement and position of each element is approximate and must be viewed as such. Intending purchasers should therefore satisfy themselves by inspection or otherwise as to their correctness. The vendors do not make or give, and neither Ashtons nor any person in their employment has any authority to make or give, any representation or warranty whatsoever in relation to this property. We offer a wide range of services through third party providers including solicitors, surveyors, removal firms, mortgage providers and EPC suppliers. We receive additional payments for administering suppliers quoting software and making referrals. You are not under any obligations to use these services and it is your discretion whether you choose to deal with these parties or your own preferred supplier. You should be aware the average payment we received in 2024 equated to £29.76 per referral.