

 3 Bedrooms

 2 Bathrooms

 1 Reception

 EPC Band B

Leasehold

Council Tax Band:
E £0.00 ()



Rarely available ground floor apartment in sought after over 55's development, offering 3 bedrooms, private courtyard garden, allocated parking, excellently decorated.

Description

Located in a sought-after over 55's development, this spacious ground floor apartment offers private outdoor space. Milton House residents enjoy a lounge and parking. The living room opens to a private paved terrace with space for a bench and table. The open-plan kitchen features fitted appliances and storage. A separate dining room can serve as a third bedroom. The principal bedroom includes fitted wardrobes and an en-suite shower room. The second bedroom has rear aspect windows. There's a bathroom with bath, WC, and basin. King Harry Park is in St Stephens Parish, south of the City, about 1.5 miles from the centre, with a nearby bus stop. Easy access to M25 and M1 for commuting to London. Council Tax Band E: £2,731.79 (2024/2025). Service charge: approx. £254 pcm. Ground rent: £175 twice yearly (£350 total). Tenure: Leasehold, 999 years from 1st July 2012.

Location

King Harry Park, in St Stephens Parish on the south side of the City, is 1.5 miles from the centre. A bus stop is nearby, and commuting to London by car is easy via the M25 and M1, both a short drive away.



Buyers Information: - In compliance with the UK's Anti Money Laundering (AML) regulations, we are required to confirm the identity of all prospective buyers at the point of an offer being accepted and use a third party, Identity Verification System to do so. There is a nominal charge of £48 (per person) including VAT for this service. For more information, please refer to the terms and conditions section of our website.





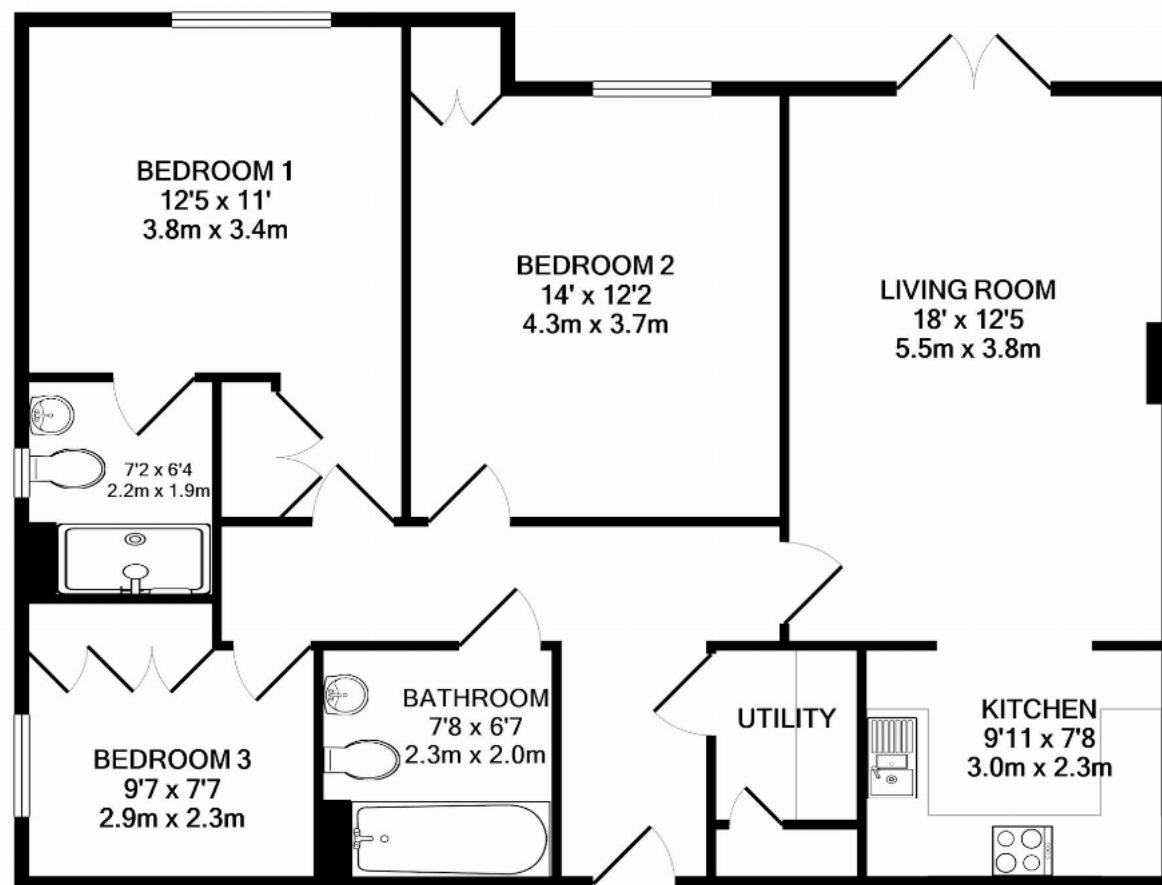

TOTAL APPROX. FLOOR AREA 977 SQ.FT. (90.8 SQ.M.)
 Made with Metropix ©2019

This floor plan is for illustrative purposes only. The measurement and position of each element is approximate and must be viewed as such.

Important Information These particulars do not constitute an offer or contract in whole or part. The statements contained herein are made without responsibility on the part of Ashtons or the vendors and they cannot be relied upon as representatives of fact. In respect of floor plans, these are for illustrative purposes only. The measurement and position of each element is approximate and must be viewed as such. Intending purchasers should therefore satisfy themselves by inspection or otherwise as to their correctness. The vendors do not make or give, and neither Ashtons nor any person in their employment has any authority to make or give, any representation or warranty whatsoever in relation to this property. We offer a wide range of services through third party providers including solicitors, surveyors, removal firms, mortgage providers and EPC suppliers. We receive additional payments for administering suppliers quoting software and making referrals. You are not under any obligations to use these services and it is your discretion whether you choose to deal with these parties or your own preferred supplier. You should be aware the average payment we received in 2024 equated to £29.76 per referral.