





-  1 Bedroom
-  1 Bathroom
-  1 Reception
-  EPC Band D

Council Tax Band:
B £1,755.54 (2025/26)



A light and bright 2nd floor flat a short walk from the mainline station, conveniently surrounded by the amenities of the Fleetville area.

Description

Great location for Fleetville's amenities, just 0.5 miles to the station. This top floor apartment has been recently decorated with new carpets throughout. It features an entrance hall leading to a good size open plan living room/kitchen. The kitchen area, separated by a breakfast bar, includes appliances such as a fridge freezer, washing machine, electric oven, and hob. The property also offers a double bedroom with fitted wardrobes and a modern bathroom suite with shower. Grimsdyke Lodge, located on Hatfield Road, provides easy access to shops, is a short walk from the mainline train station, and is close to St Albans City centre. A highly convenient location.

Location

Grimsdyke Lodge on Hatfield Road offers easy access to shops and is just a short walk from the mainline train station. The main St Albans City centre is also nearby, making it a very convenient location.





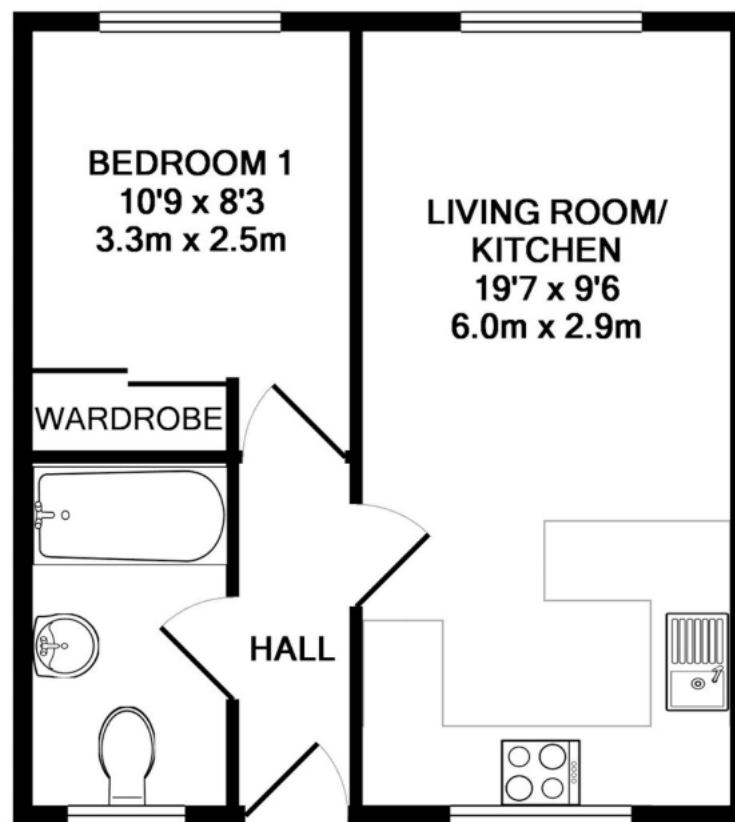

TOTAL APPROX. FLOOR AREA 347 SQ.FT. (32.2 SQ.M.)
Made with Metropix ©2018

Important Information These particulars do not constitute an offer or contract in whole or part. The statements contained herein are made without responsibility on the part of Ashtons or the vendors and they cannot be relied upon as representatives of fact. In respect of floor plans, these are for illustrative purposes only. The measurement and position of each element is approximate and must be viewed as such. Intending purchasers should therefore satisfy themselves by inspection or otherwise as to their correctness. The vendors do not make or give, and neither Ashtons nor any person in their employment has any authority to make or give, any representation or warranty whatsoever in relation to this property. We offer a wide range of services through third party providers including solicitors, surveyors, removal firms, mortgage providers and EPC suppliers. We receive additional payments for administering suppliers quoting software and making referrals. You are not under any obligations to use these services and it is your discretion whether you choose to deal with these parties or your own preferred supplier. You should be aware the average payment we received in 2024 equated to £29.76 per referral.