 3 Bedrooms

 1 Bathroom

 2 Receptions

 66ft

 On-Street Parking

Freehold

Council Tax Band:
D £2,368.36 (2026/2027)

Local Authority:
St Albans City & District Council



 **ashtons**
for life's great moves

Burnham Road, St. Albans, AL1 4QN
Guide price of £825,000

Stunning three-bedroom family home in a popular area, close to local shops and city centre.

Description

Located on the sought-after Burnham Road, St Albans, this impeccably maintained home offers spacious accommodation over three floors, perfect for modern family living. The ground floor boasts an inviting entrance hall, a bright living room with a bay window, and a generous dining area that flows into the impressive kitchen/breakfast room. The kitchen opens to the garden, ideal for indoor-outdoor living. The first floor includes three well-proportioned bedrooms; two are doubles, and a third serves as a child's room, guest space, or office, all served by a contemporary family bathroom. The loft has been converted into a versatile additional space, suitable for use as a home office, hobby area, or guest room. The property also features a large rear garden, perfect for family activities and relaxation. Presented in stunning condition, this home offers character, style, and practicality in a desirable location, close to top schools, transport, and St Albans city centre amenities.

Location

Burnham Road is in Fleetville, east of St Albans, near the city centre's amenities with local shops and restaurants. Well-regarded schools are nearby, and it's less than a mile from the mainline station with fast rail links to central London.



In compliance with the UK's Anti Money Laundering (AML) regulations, we are required to confirm the identity of all prospective buyers at the point of an offer being accepted and use a third party, Identity Verification System to do so. There is a nominal charge of £48 (per person) including VAT for this service. For more information, please refer to the terms and conditions section of our website.





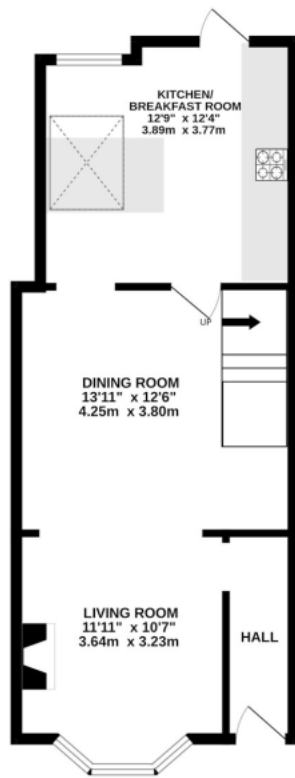

GROUND FLOOR
477 sq.ft. (44.3 sq.m.) approx.

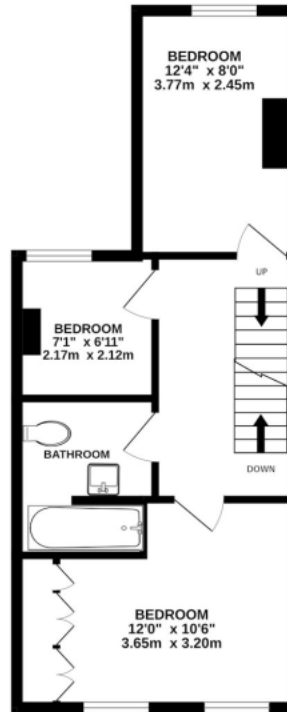

1ST FLOOR
410 sq.ft. (38.1 sq.m.) approx.

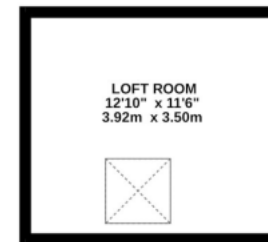

2ND FLOOR
148 sq.ft. (13.7 sq.m.) approx.

TOTAL FLOOR AREA: 1035 sq.ft. (96.1 sq.m.) approx.

This floor plan is for illustrative purposes only. The measurement and position of each element is approximate and must be viewed as such

Important Information These particulars do not constitute an offer or contract in whole or part. The statements contained herein are made without responsibility on the part of Ashtons or the vendors and they cannot be relied upon as representatives of fact. In respect of floor plans, these are for illustrative purposes only. The measurement and position of each element is approximate and must be viewed as such. Intending purchasers should therefore satisfy themselves by inspection or otherwise as to their correctness. The vendors do not make or give, and neither Ashtons nor any person in their employment has any authority to make or give, any representation or warranty whatsoever in relation to this property. We offer a wide range of services through third party providers including solicitors, surveyors, removal firms, mortgage providers and EPC suppliers. We receive additional payments for administering suppliers quoting software and making referrals. You are not under any obligations to use these services and it is your discretion whether you choose to deal with these parties or your own preferred supplier. You should be aware the average payment we received in 2024 equated to £29.76 per referral.