



3 bedrooms



1 bathroom



2 receptions



Private Garden



Garage & Off-Street
Parking



EPC Band D

Freehold

Council Tax Band:
E £2,878.19 (2025/2026)

Local Authority:
St Albans City & District Council



Stunning 3-bed semi-detached home in immaculate condition, offering stylish and spacious family living. Situated on a desirable London Colney road, with easy access to local amenities and excellent schools.

Description

The ground floor comprises a generous open-plan living and dining room, providing a bright and versatile space perfect for both relaxing and entertaining. To the rear, a stunning high-spec kitchen features a large central island, contemporary fitted appliances, and ample built-in storage. Adjacent to the kitchen is a gym area that could easily double as a study or utility space, adding to the home's flexibility. Upstairs, the first floor hosts three well-proportioned bedrooms. The principal bedroom enjoys a peaceful rear aspect and generous dimensions, while the second and third bedrooms offer ideal accommodation for family, guests, or a home office. A sleek family bathroom completes the upper level. Externally, the property boasts a beautifully landscaped rear garden with a spacious patio area, perfect for alfresco dining and summer gatherings, alongside low-maintenance artificial turf. A garage and a summer house provide additional storage and leisure space, making this an exceptionally well-rounded home.

Location

London Colney, southwest of St Albans, offers easy access to city amenities. St Albans City and Radlett Stations provide routes to London. The property is also walking distance from Colney Fields Retail Park.

Buyers Information

In compliance with the UK's Anti Money Laundering (AML) regulations, we are required to confirm the identity of all prospective buyers at the point of an offer being accepted and use a third party, Identity Verification System to do so. There is a nominal charge of £48 (per person) including VAT for this service. For more information, please refer to the terms and conditions section of our website.







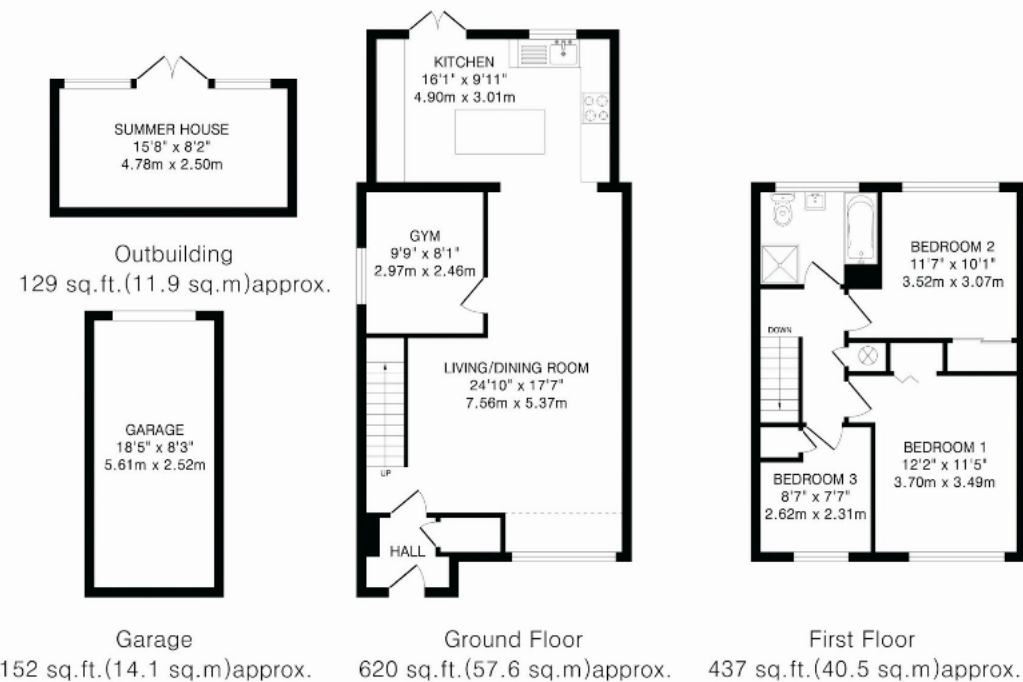

TOTAL FLOOR AREA: 1338 sq.ft.(124.1 sq.m)approx.

This floorplan is for illustration purposes only. The measurements and position of each element are approximate and must be viewed as such.

Important Information These particulars do not constitute an offer or contract in whole or part. The statements contained herein are made without responsibility on the part of Ashtons or the vendors and they cannot be relied upon as representatives of fact. In respect of floor plans, these are for illustrative purposes only. The measurement and position of each element is approximate and must be viewed as such. Intending purchasers should therefore satisfy themselves by inspection or otherwise as to their correctness. The vendors do not make or give, and neither Ashtons nor any person in their employment has any authority to make or give, any representation or warranty whatsoever in relation to this property. We offer a wide range of services through third party providers including solicitors, surveyors, removal firms, mortgage providers and EPC suppliers. We receive additional payments for administering suppliers quoting software and making referrals. You are not under any obligations to use these services and it is your discretion whether you choose to deal with these parties or your own preferred supplier. You should be aware the average payment we received in 2024 equated to £29.76 per referral.