 4 Bedrooms

 3 Bathrooms

 1 Reception

Freehold





**SHOW HOME LAUNCHING SAT 27TH SEPTEMBER! A rare development of 2 luxury detached homes in beautiful Berkhamsted. Call now to book your Appointment!**

### Description

Tucked away at a peaceful no-through road in Berkhamsted, this exclusive development by Resolution Homes offers a chance to own one of two unique detached residences. Each home combines elegance with cutting-edge specifications, offering style, space, and comfort. Two reception rooms include a sitting room with a feature fireplace and a separate study. The heart is a Hacker German designer kitchen, with Quartz Carrera worktops and Bosch appliances, flowing into the dining area. The first floor has three double bedrooms, one with en-suite, and a high-spec family bathroom. The second floor is a master suite with en-suite and walk-in wardrobe. Bathrooms feature Porcelanosa tiling and Crosswater sanitaryware. South west-facing gardens are landscaped for low-maintenance elegance. Extras include bike and bin stores and private driveway. Highlights: underfloor heating, MVHR system, PV solar panels, luxury finishes. Ready to move in! Show Home now available. Call us for more info or to view!

Buyers Information: - In compliance with the UK's Anti Money Laundering (AML) regulations, we are required to confirm the identity of all prospective buyers at the point of an offer being accepted and use a third party, Identity Verification System to do so. There is a nominal charge of £48 (per person) including VAT for this service. For more information, please refer to the terms and conditions section of our website.











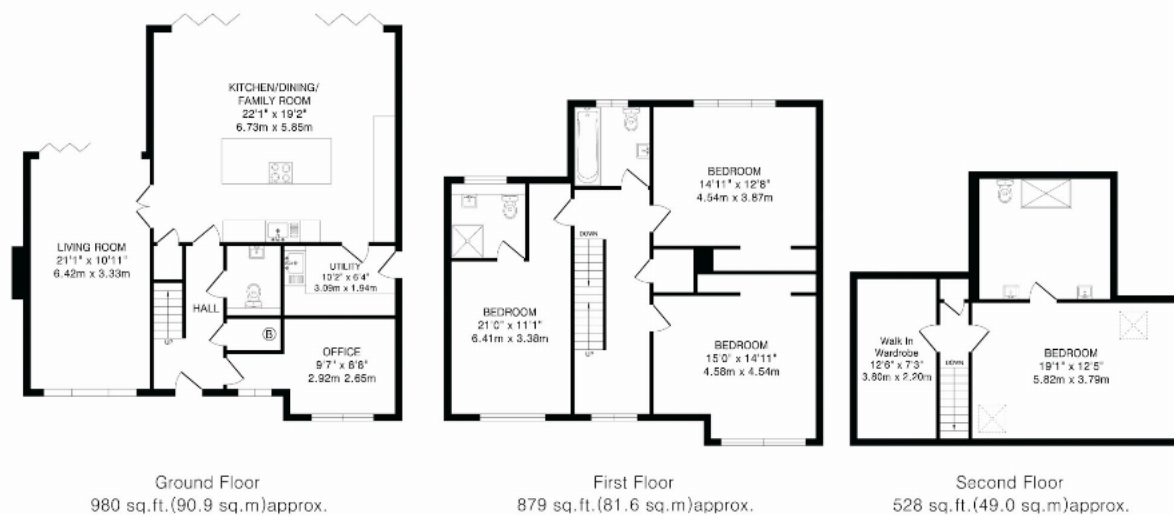

TOTAL FLOOR AREA: 2387 sq.ft.(221.5 sq.m)approx.  
This floorplan is for illustration purposes only. The measurements and position of each element are approximate and must be viewed as such.



Floor plan produced in accordance with RICS Property Measurement 2nd Edition. Although Pink Plan Ltd ensures the highest level of accuracy, measurements of doors, windows and rooms are approximate and no responsibility is taken for error, omission or misstatement. These plans are for representation purposes only and no guarantee is given on the total square footage of the property within this plan. The figure icon is for initial guidance only and should not be relied on as a basis of valuation.



**Important Information** These particulars do not constitute an offer or contract in whole or part. The statements contained herein are made without responsibility on the part of Ashtons or the vendors and they cannot be relied upon as representatives of fact. In respect of floor plans, these are for illustrative purposes only. The measurement and position of each element is approximate and must be viewed as such. Intending purchasers should therefore satisfy themselves by inspection or otherwise as to their correctness. The vendors do not make or give, and neither Ashtons nor any person in their employment has any authority to make or give, any representation or warranty whatsoever in relation to this property. We offer a wide range of services through third party providers including solicitors, surveyors, removal firms, mortgage providers and EPC suppliers. We receive additional payments for administering suppliers quoting software and making referrals. You are not under any obligations to use these services and it is your discretion whether you choose to deal with these parties or your own preferred supplier. You should be aware the average payment we received in 2024 equated to £29.76 per referral.