

 2 Bedrooms

 1 Bathroom

 1 Reception

 EPC Band C

Freehold



Plot 1015, The Osbourne, 2-bedroom semi-detached, 851 sq ft, private garden. *Off-Plan Reservations Available – Book an Appointment Today!*

Description

Ascots Green embodies Sir Ebenezer Howard's vision, offering a community of 340 traditionally-inspired homes, from one-bedroom apartments to five-bedroom family homes, blending rural and urban living. Featuring a central square, 47 acres of open space, and architectural designs influenced by local and natural elements, Ascots Green ensures a distinct identity. Homes draw inspiration from the local vernacular and original Garden City phases, integrating modern materials and technology. Plot 1015, The Osbourne, is a 2-bedroom semi-detached house with 851 sq ft of space and a private garden. *Off-Plan Reservations Now Being Taken – Arrange an Appointment to Discuss Today!*

Residents will enjoy cultural and retail experiences, a new home for Hatfield & Crusaders cricket club, expansive open spaces, community orchard, and playgrounds. Disclaimer: Photographs are illustrative from a previous development. CGIs and floorplans are subject to change. Consult the sales team for current details.

Location

Ascots Green nestles between country towns and green spaces. With Welwyn and Hatfield nearby, find shops and eateries, plus Hertford a short ride away. Enjoy Hatfield Park, historic woodlands, and leisure trails for scenic countryside and walks.

Buyers Information: - In compliance with the UK's Anti Money Laundering (AML) regulations, we are required to confirm the identity of all prospective buyers at the point of an offer being accepted and use a third party, Identity Verification System to do so. There is a nominal charge of £48 (per person) including VAT for this service. For more information, please refer to the terms and conditions section of our website.





Ascots Green

The Osborne - Type 1 2 bedroom home

Plots as drawn: 1015, 1061 and 1079
Handed: 1014, 1059 and 1078

80.02 sq.m / 863 sq.ft



GROUND FLOOR

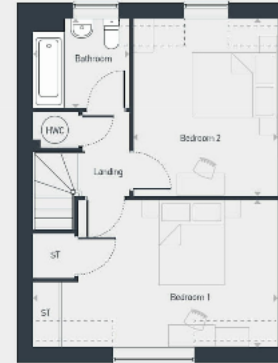

FIRST FLOOR

ST: Stairs WC: Water Closet HWC: Hot Water Cylinder --- Reduced Head Height * Window to plots 1014 and 1061 only

DIMENSIONS	m	ft
Living/Kitchen/Dining	7.34m x 4.45m	24'1" x 14'7"
Utility	1.96m x 1.88m	6'3" x 5'10"

DIMENSIONS	m	ft
Bedroom 1	5.44m x 3.29m	17'11" x 10'9"
Bedroom 2	3.96m x 3.22m	12'11" x 10'7"
Bathroom	2.15m x 2.00m	7'0" x 6'6"



01707 515 001 | ascotsgreen@placesforpeople.co.uk
Ascots Lane, Welwyn Hatfield AL7 4HL

Please note: All layouts and floor plans, configurations, maps and information are intended for guidance only and accuracy of this information cannot be relied upon by prospective purchasers who must make their own enquiries to satisfy themselves by inspection or otherwise as to the correct details.

Important Information These particulars do not constitute an offer or contract in whole or part. The statements contained herein are made without responsibility on the part of Ashtons or the vendors and they cannot be relied upon as representatives of fact. In respect of floor plans, these are for illustrative purposes only. The measurement and position of each element is approximate and must be viewed as such. Intending purchasers should therefore satisfy themselves by inspection or otherwise as to their correctness. The vendors do not make or give, and neither Ashtons nor any person in their employment has any authority to make or give, any representation or warranty whatsoever in relation to this property. We offer a wide range of services through third party providers including solicitors, surveyors, removal firms, mortgage providers and EPC suppliers. We receive additional payments for administering suppliers quoting software and making referrals. You are not under any obligations to use these services and it is your discretion whether you choose to deal with these parties or your own preferred supplier. You should be aware the average payment we received in 2024 equated to £29.76 per referral.



01462 453195 | newhomes@ashtons.co.uk | ashtons.co.uk

Berkhamsted | Harpenden | Hertford | Hitchin | Redbourn | St Albans | Welwyn Garden City