





-  5 Bedrooms
-  4 Bathrooms
-  2 Receptions
-  Private Garden
-  Garage & Driveway



Freehold

Council Tax Band:  
G £4,096.96 (2026/2027)

Local Authority:  
St Albans District Council

 **ashtons**  
for life's great moves

Wheatfield Avenue, Harpenden, Hertfordshire, AL5 2NU  
Guide price of £2,400,000

Spacious five-bedroom detached family home offering generous accommodation throughout.

### Description

Situated in a prestigious location at the heart of the sought-after West Common area, this exceptional family home offers spacious, versatile accommodation presented to an outstanding standard throughout. Arranged over two floors, the property features five generous double bedrooms, three with en-suite facilities, alongside a stylish family bathroom. A striking Minstrel galleried landing adds to the home's sense of space and character. The magnificent reception hall creates a grand first impression, complemented by an elegant Gull Wing staircase and ground-floor cloakroom. Flexible living accommodation includes a superb sitting room with a gas fireplace and French doors opening onto the garden, a separate dining room, and two ground-floor bedrooms with en-suite shower rooms. The kitchen/dining room is fitted with wall and base units, a central island, and integrated appliances. French doors provide garden access, ideal for living and entertaining. A separate utility room offers additional storage. The house also includes a built-in Hoover and Sonos sound system. Outside, the private south-easterly facing rear garden features a patio, lawn, and flower borders. There's also a garden room/gym with electricity, heating, and internet. To the front, a generous driveway leads to a double garage with light, power, and an electric door.

### Location

Situated in the heart of West Common, Wheatfield Avenue is a highly regarded and sought after location. This quiet residential setting provides an array of charming homes and the glorious plots.



In compliance with the UK's Anti Money Laundering (AML) regulations, we are required to confirm the identity of all prospective buyers at the point of an offer being accepted and use a third party, Identity Verification System to do so. There is a nominal charge of £48 (per person) including VAT for this service. For more information, please refer to the terms and conditions section of our website.





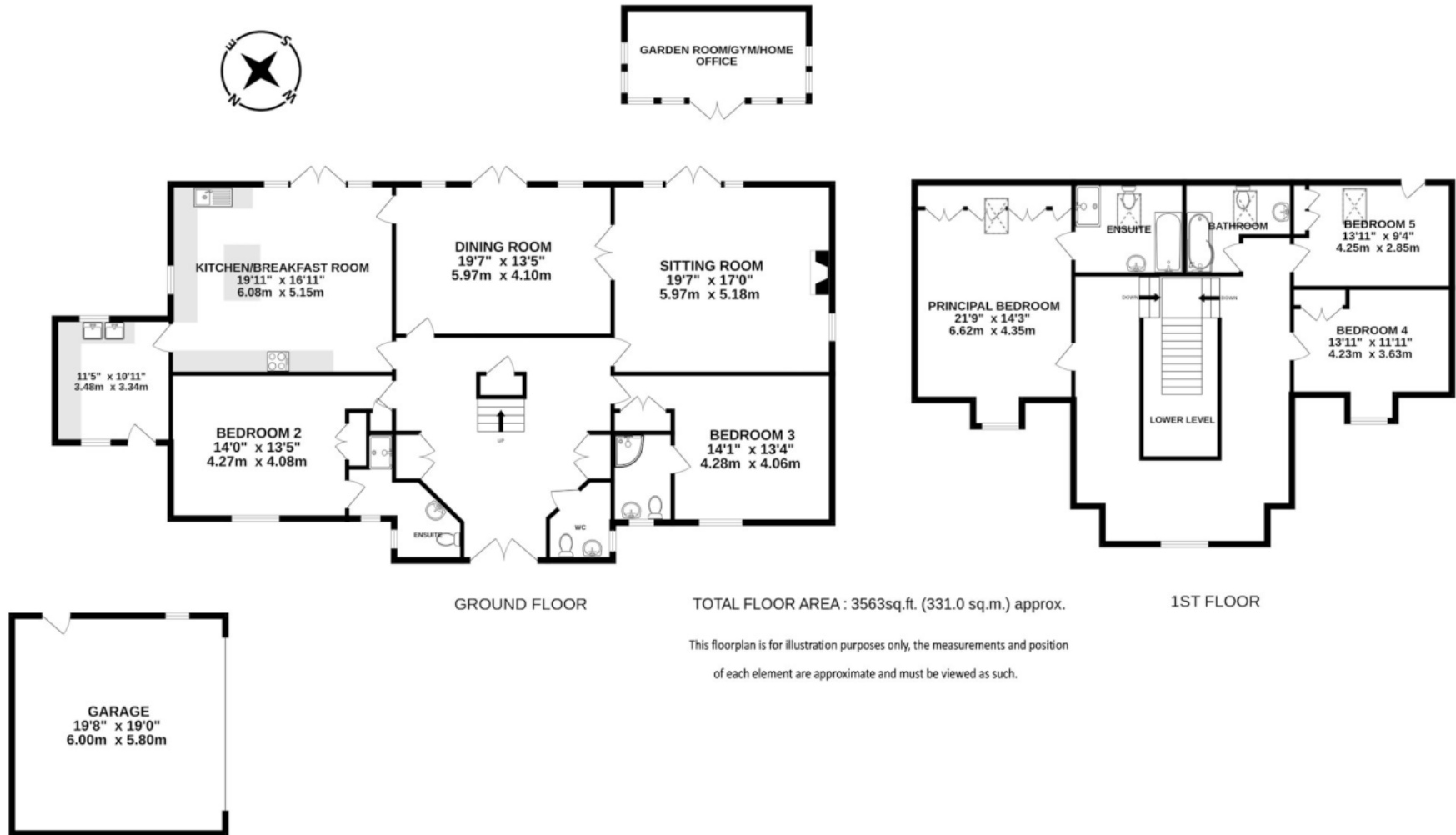

This floorplan is for illustration purposes only, the measurements and position of each element are approximate and must be viewed as such.

**Important Information** These particulars do not constitute an offer or contract in whole or part. The statements contained herein are made without responsibility on the part of Ashtons or the vendors and they cannot be relied upon as representatives of fact. In respect of floor plans, these are for illustrative purposes only. The measurement and position of each element is approximate and must be viewed as such. Intending purchasers should therefore satisfy themselves by inspection or otherwise as to their correctness. The vendors do not make or give, and neither Ashtons nor any person in their employment has any authority to make or give, any representation or warranty whatsoever in relation to this property. We offer a wide range of services through third party providers including solicitors, surveyors, removal firms, mortgage providers and EPC suppliers. We receive additional payments for administering suppliers quoting software and making referrals. You are not under any obligations to use these services and it is your discretion whether you choose to deal with these parties or your own preferred supplier. You should be aware the average payment we received in 2024 equated to £29.76 per referral.