

 3 Bedrooms

 1 Bathroom

 1 Reception

 Communal Garden

 Residence Parking

 EPC Band C

Leasehold (944 years remaining)

Service Charge:
£2,300.00 per annum

Council Tax Band:
D £2,458.18 (2026/2027)

Local Authority:
St Albans District Council



Refurbished 3-bed first-floor apartment in central Harpenden with balcony, luxury finish, and short walk to station.

Description

Situated on the first floor of a prestigious development in central Harpenden, this beautifully presented apartment has been meticulously refurbished to an exceptional standard, offering a stylish and contemporary home ready for immediate occupation. The well-balanced accommodation features a welcoming entrance hall, a spacious living and dining room with access to a private, expansive balcony, and a superbly appointed kitchen fitted with high-quality cabinetry and integrated appliances. There are three well-proportioned bedrooms, including a generous principal bedroom, all served by a luxurious modern bathroom and a separate cloakroom, both boasting high-spec finishes. The comprehensive refurbishment includes significant upgrades throughout, resulting in a bright, sophisticated apartment that merges modern living with practical accommodation. Further benefits include well-maintained communal grounds and excellent access to Harpenden town centre, station, and local amenities.

Location

Carlton Court is an attractive development of apartments and town-houses set in fine communal gardens. Located on Carlton Road the property is ideal for access to the town centre with its wide range of shops and restaurants.

In compliance with the UK's Anti Money Laundering (AML) regulations, we are required to confirm the identity of all prospective buyers at the point of an offer being accepted and use a third party, Identity Verification System to do so. There is a nominal charge of £48 (per person) including VAT for this service. For more information, please refer to the terms and conditions section of our website.







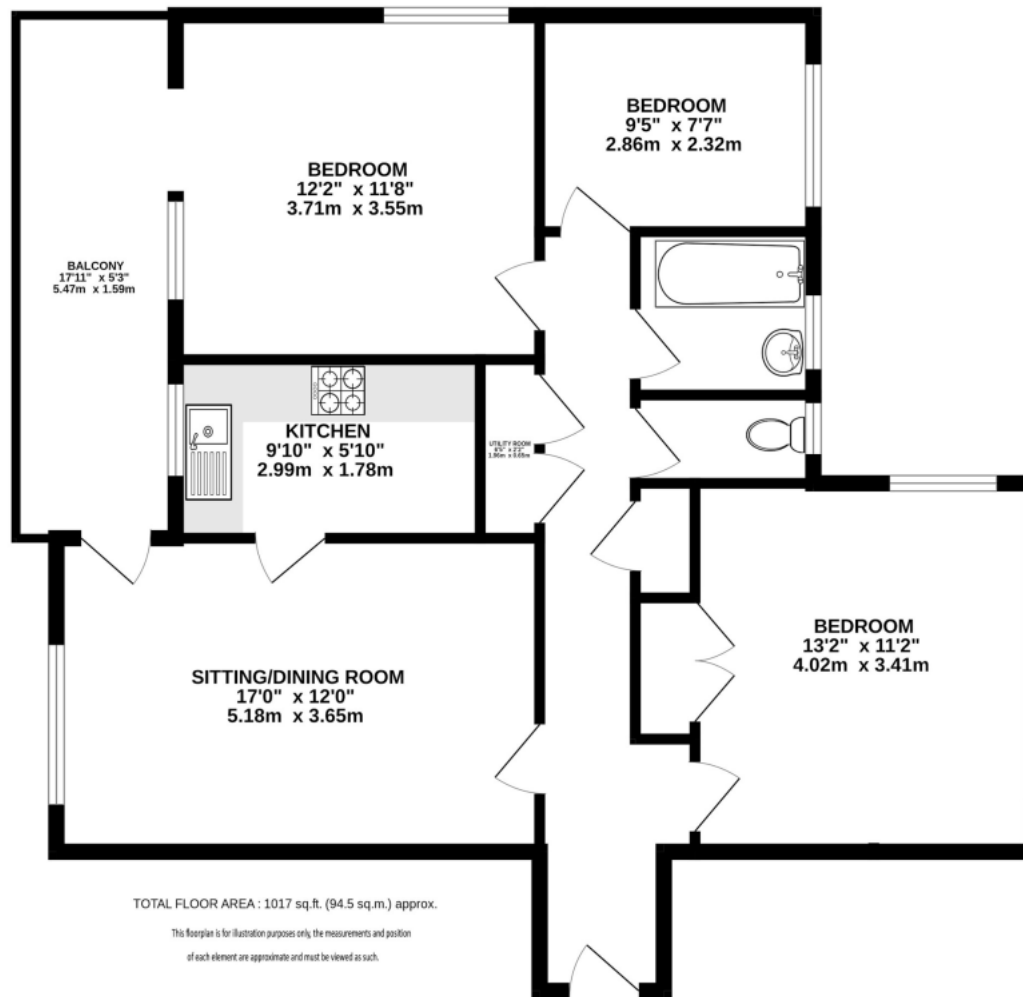

Important Information These particulars do not constitute an offer or contract in whole or part. The statements contained herein are made without responsibility on the part of Ashtons or the vendors and they cannot be relied upon as representatives of fact. In respect of floor plans, these are for illustrative purposes only. The measurement and position of each element is approximate and must be viewed as such. Intending purchasers should therefore satisfy themselves by inspection or otherwise as to their correctness. The vendors do not make or give, and neither Ashtons nor any person in their employment has any authority to make or give, any representation or warranty whatsoever in relation to this property. We offer a wide range of services through third party providers including solicitors, surveyors, removal firms, mortgage providers and EPC suppliers. We receive additional payments for administering suppliers quoting software and making referrals. You are not under any obligations to use these services and it is your discretion whether you choose to deal with these parties or your own preferred supplier. You should be aware the average payment we received in 2024 equated to £29.76 per referral.