

 3 Bedrooms

 1 Bathroom

 1 Reception

 Private Garden

 Garage & Driveway

 EPC Band D



Freehold

Council Tax Band:
E £3,005.63 (2026/2027)

Local Authority:
St Albans District Council

 **ashtons**
for life's great moves

Manor Road, Wheathampstead, AL4 8JD
Guide price of £750,000

Spacious detached bungalow with large garden and countryside views.

Description

This bright and airy bungalow, situated on a peaceful No-Through-Road, is equidistant to Harpenden and Wheathampstead village centres. The spacious and versatile accommodation includes three bedrooms and a family bathroom with a separate shower cubicle. The large double aspect lounge/dining room features sliding patio doors to the rear garden, while the fitted kitchen/breakfast room boasts built-in appliances, including a gas hob, extractor fan, fan-assisted oven, and space for a dishwasher and fridge/freezer. Outside, the beautiful gardens feature a large entertaining patio, an expanse of lawn, and well-stocked flower and shrub borders. Gated access leads to a magnificent orchard, mostly laid to lawn, backing onto open countryside. At the front, there's driveway parking for several vehicles leading to a single garage with power and light.

Location

Accessed from Lower Luton Road, Manor Road offers a convenient location and is ideally situated between Harpenden and the village of Wheathampstead



In compliance with the UK's Anti Money Laundering (AML) regulations, we are required to confirm the identity of all prospective buyers at the point of an offer being accepted and use a third party, Identity Verification System to do so. There is a nominal charge of £48 (per person) including VAT for this service. For more information, please refer to the terms and conditions section of our website.





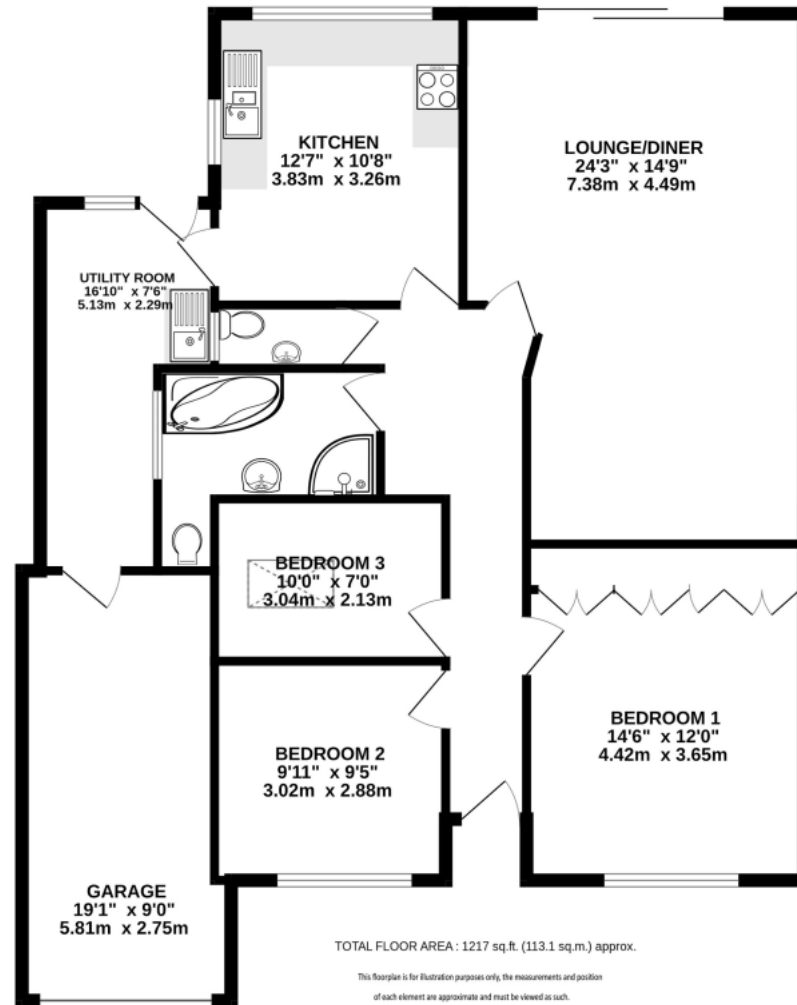

Important Information These particulars do not constitute an offer or contract in whole or part. The statements contained herein are made without responsibility on the part of Ashtons or the vendors and they cannot be relied upon as representatives of fact. In respect of floor plans, these are for illustrative purposes only. The measurement and position of each element is approximate and must be viewed as such. Intending purchasers should therefore satisfy themselves by inspection or otherwise as to their correctness. The vendors do not make or give, and neither Ashtons nor any person in their employment has any authority to make or give, any representation or warranty whatsoever in relation to this property. We offer a wide range of services through third party providers including solicitors, surveyors, removal firms, mortgage providers and EPC suppliers. We receive additional payments for administering suppliers quoting software and making referrals. You are not under any obligations to use these services and it is your discretion whether you choose to deal with these parties or your own preferred supplier. You should be aware the average payment we received in 2024 equated to £29.76 per referral.