



2 Bedrooms



1 Bathroom



1 Reception



EPC Band C

Council Tax Band:  
D £0.00 ()



Extremely spacious 2nd floor apartment with ample parking in a highly regarded location, moments from the town centre and mainline station.

### Description

This well-presented apartment offers a spacious, light-filled lounge/dining area with views overlooking the peaceful communal gardens, along with a large kitchen with integrated appliances and plenty of cupboard and worktop space. There are two generously sized bedrooms, both with built-in wardrobes, and a bathroom fitted with a bath and overhead shower. Residents' parking and visitor bays are available on-site. The apartment is offered part furnished however can be available unfurnished upon request. The property can be available for a 6 / 9 / 12 month tenancy.

### Location

Chepstow, in Harpenden's 'Avenues', offers Edwardian charm with later architectural touches. A wide, peaceful road with top conveniences: near Roundwood Park School, the High Street, Station (25 mins to St Pancras), and Rothamsted Park.



Buyers Information: - In compliance with the UK's Anti Money Laundering (AML) regulations, we are required to confirm the identity of all prospective buyers at the point of an offer being accepted and use a third party, Identity Verification System to do so. There is a nominal charge of £48 (per person) including VAT for this service. For more information, please refer to the terms and conditions section of our website.











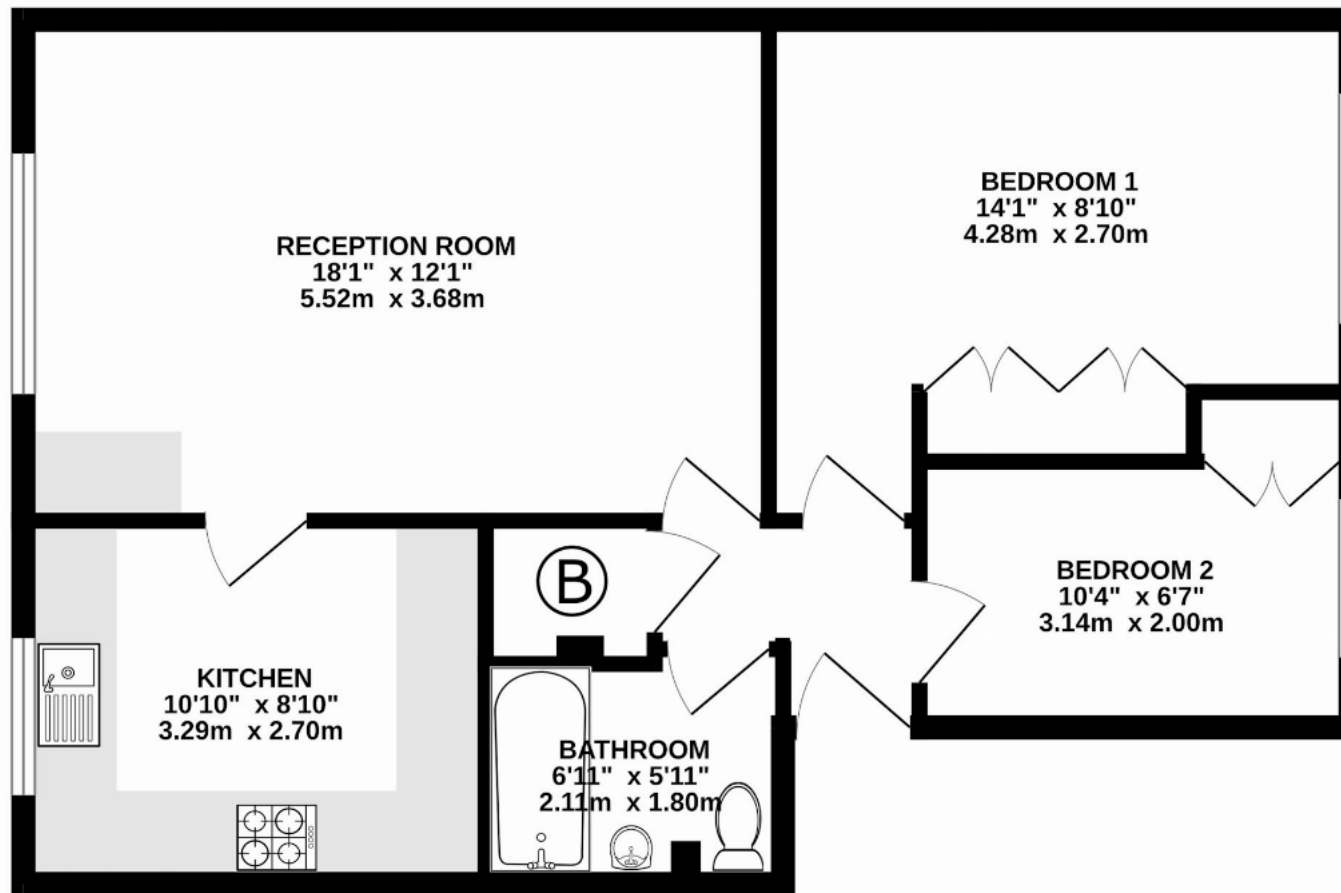

TOTAL FLOOR AREA : 623 sq.ft. (57.8 sq.m.) approx.

This floorplan is for illustration purposes only. The measurements and position of each element are approximate and must be viewed as such.

**Important Information** These particulars do not constitute an offer or contract in whole or part. The statements contained herein are made without responsibility on the part of Ashtons or the vendors and they cannot be relied upon as representatives of fact. In respect of floor plans, these are for illustrative purposes only. The measurement and position of each element is approximate and must be viewed as such. Intending purchasers should therefore satisfy themselves by inspection or otherwise as to their correctness. The vendors do not make or give, and neither Ashtons nor any person in their employment has any authority to make or give, any representation or warranty whatsoever in relation to this property. We offer a wide range of services through third party providers including solicitors, surveyors, removal firms, mortgage providers and EPC suppliers. We receive additional payments for administering suppliers quoting software and making referrals. You are not under any obligations to use these services and it is your discretion whether you choose to deal with these parties or your own preferred supplier. You should be aware the average payment we received in 2024 equated to £29.76 per referral.