

-  1 Bedroom
-  1 Bathroom
-  1 Reception
-  Communal
-  Residents Parking
-  EPC Band C

Leasehold

Council Tax Band:  
C £2,082.29 (2025/26)

Local Authority:  
St Albans District Council





**NO ONWARD CHAIN.** A spacious one bedroom first floor apartment set in a popular development close to excellent facilities.

### Description

Set in a popular development, this spacious first-floor apartment offers an excellent opportunity for first-time buyers and investors. The property consists of an entrance hall with entry phone system, a good-sized double bedroom, and white bathroom suite. The bright and airy lounge has views over communal gardens and leads to the fitted kitchen with built-in utilities including an electric oven, four-burner gas hob, and extractor fan above. This fine apartment also benefits from an allocated parking space and ample visitors parking. Council Tax Band: C £2,082.29 April 25/March 26. Lease details 999 years from 1990, Maintenance £900 pa, Peppercorn Rent.

### Location

Balfour Court offers a charming setting opposite the Lea Valley nature reserve and close to a range of shops and pubs. Harpenden town centre & station are approximately one mile away .



Buyers Information - In compliance with the UK's Anti Money Laundering (AML) regulations, we are required to confirm the identity of all prospective buyers at the point of an offer being accepted and use a third party, Identity Verification System to do so. There is a nominal charge of £48 (per person) including VAT for this service. For more information, please refer to the terms and conditions section of our website











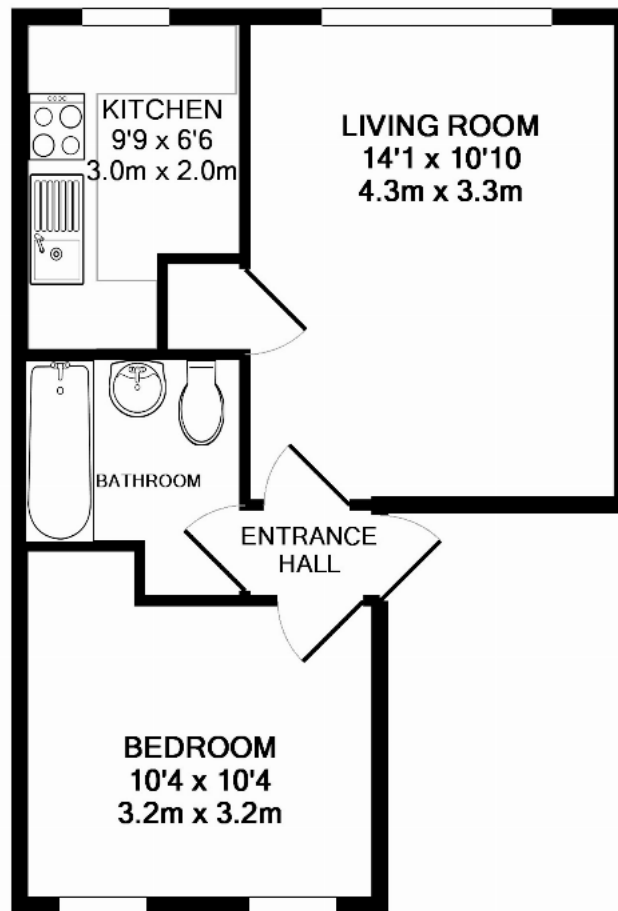

TOTAL APPROX. FLOOR AREA 362 SQ.FT. (33.6 SQ.M.)

This floorplan is for illustration purposes only. The measurements and position of each element are approximate and must be viewed as such.

**Important Information** These particulars do not constitute an offer or contract in whole or part. The statements contained herein are made without responsibility on the part of Ashtons or the vendors and they cannot be relied upon as representatives of fact. In respect of floor plans, these are for illustrative purposes only. The measurement and position of each element is approximate and must be viewed as such. Intending purchasers should therefore satisfy themselves by inspection or otherwise as to their correctness. The vendors do not make or give, and neither Ashtons nor any person in their employment has any authority to make or give, any representation or warranty whatsoever in relation to this property. We offer a wide range of services through third party providers including solicitors, surveyors, removal firms, mortgage providers and EPC suppliers. We receive additional payments for administering suppliers quoting software and making referrals. You are not under any obligations to use these services and it is your discretion whether you choose to deal with these parties or your own preferred supplier. You should be aware the average payment we received in 2024 equated to £29.76 per referral.