





-  1 Bedroom
-  1 Bathroom
-  2 Receptions
-  EPC Band C

Council Tax Band:
C £0.00 ()



Ground floor apartment with one double bedroom and a small study, set in a quiet residential area near Harpenden.

Description

Charming ground floor apartment in St James Court Development offers a spacious double bedroom and a small study room. The entrance hall features a coat cupboard, additional storage, and an entry phone system. The open-plan kitchen and living area provide generous space, with the newly fitted kitchen boasting a good range of units and appliances. The main bedroom includes built-in wardrobes, and the further room can serve as a study. The bathroom features a bath with shower over. Well-kept communal gardens, ample off-road parking, and a bike storage area are included.

Location

St. James Court, Clarendon Road, offers a charming life setting near St Georges and Sir John Lawes schools. A tranquil backwater blending Harpenden's building periods. Town centre, station, parks, and playgrounds within a 15-minute walk.





GROUND FLOOR
523 sq.ft. (48.6 sq.m.) approx.

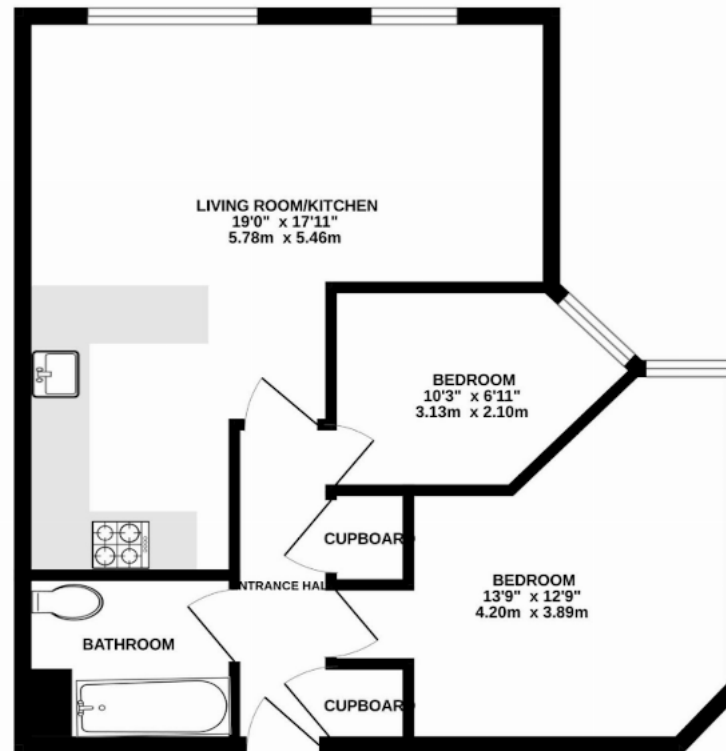

TOTAL FLOOR AREA : 523 sq.ft. (48.6 sq.m.) approx.

Important Information These particulars do not constitute an offer or contract in whole or part. The statements contained herein are made without responsibility on the part of Ashtons or the vendors and they cannot be relied upon as representatives of fact. In respect of floor plans, these are for illustrative purposes only. The measurement and position of each element is approximate and must be viewed as such. Intending purchasers should therefore satisfy themselves by inspection or otherwise as to their correctness. The vendors do not make or give, and neither Ashtons nor any person in their employment has any authority to make or give, any representation or warranty whatsoever in relation to this property. We offer a wide range of services through third party providers including solicitors, surveyors, removal firms, mortgage providers and EPC suppliers. We receive additional payments for administering suppliers quoting software and making referrals. You are not under any obligations to use these services and it is your discretion whether you choose to deal with these parties or your own preferred supplier. You should be aware the average payment we received in 2024 equated to £29.76 per referral.