 3 Bedrooms

 1 Bathroom

 1 Reception

 EPC Band D

Council Tax Band:  
C £0.00 ()



3-bed maisonette in a prime spot above a parade of shops, just 15 mins' walk to Harpenden mainline station and town centre.

### Description

Spacious three-bedroom maisonette with its own private entrance and carpeted stairs leading to the landing area. The lounge features wooden flooring and offers views over Batford Springs. The modern kitchen is well-equipped with ample worktop space and appliances, including a gas hob, electric oven, dishwasher, and washing machine. There are three well-proportioned bedrooms, along with a modern bathroom fitted with a shower over the bath. The property benefits from double glazing and gas central heating. Residents' parking is available to the rear.

### Location

Station Road offers charming homes under a mile from Harpenden station and the Victorian High Street, with schools and shops, pubs, and restaurants nearby. Enjoy stunning views over the Lea Valley Nature Reserve.





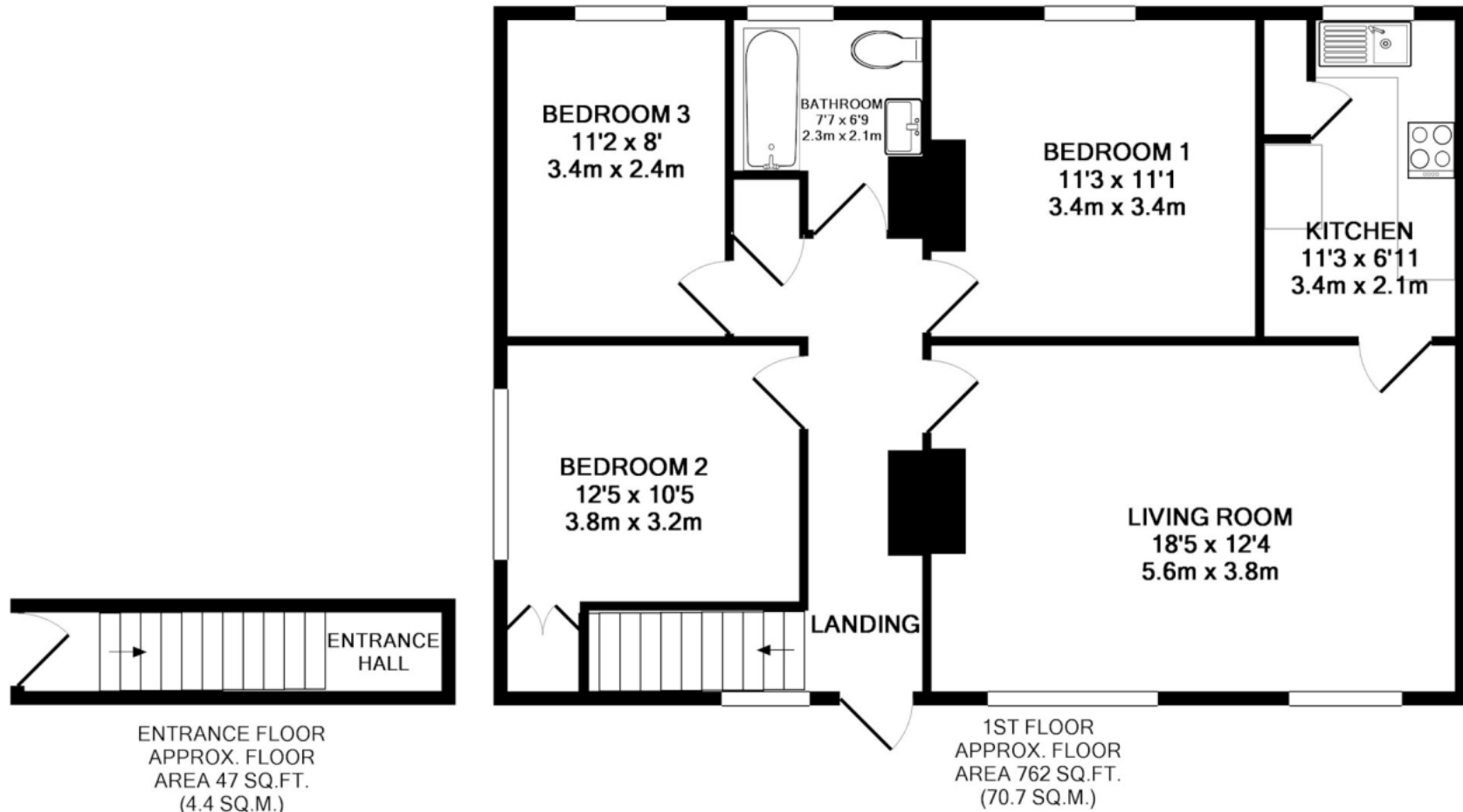

TOTAL APPROX. FLOOR AREA 809 SQ.FT. (75.1 SQ.M.)

This floorplan is for illustration purposes only. The measurements and position of each element are approximate and must be viewed as such.

**Important Information** These particulars do not constitute an offer or contract in whole or part. The statements contained herein are made without responsibility on the part of Ashtons or the vendors and they cannot be relied upon as representatives of fact. In respect of floor plans, these are for illustrative purposes only. The measurement and position of each element is approximate and must be viewed as such. Intending purchasers should therefore satisfy themselves by inspection or otherwise as to their correctness. The vendors do not make or give, and neither Ashtons nor any person in their employment has any authority to make or give, any representation or warranty whatsoever in relation to this property. We offer a wide range of services through third party providers including solicitors, surveyors, removal firms, mortgage providers and EPC suppliers. We receive additional payments for administering suppliers quoting software and making referrals. You are not under any obligations to use these services and it is your discretion whether you choose to deal with these parties or your own preferred supplier. You should be aware the average payment we received in 2024 equated to £29.76 per referral.