 2 Bedrooms

 1 Bathroom

 1 Reception

 EPC Band C

Council Tax Band:  
D £0.00 ()



Newly renovated ground floor 2-bed apartment with garage, walking distance to Harpenden Station and Town.

### Description

A beautifully renovated two-bedroom ground floor apartment, offering its own private front door via the well-maintained communal gardens. The generous lounge flows seamlessly into a newly fitted, neutral kitchen, complete with modern appliances including a gas oven and hob, washing machine, and separate fridge and freezer, plus ample worktop and cupboard space. The apartment comprises two bright and airy carpeted bedrooms, along with a family bathroom featuring a bath and overhead shower. Additional benefits include two storage cupboards and a garage.

### Location

Balfour Court offers a charming setting opposite the Lea Valley nature reserve and close to a range of shops and pubs. Harpenden town centre & station are approximately one mile away presenting direct access to St Pancras International in under 30 mi







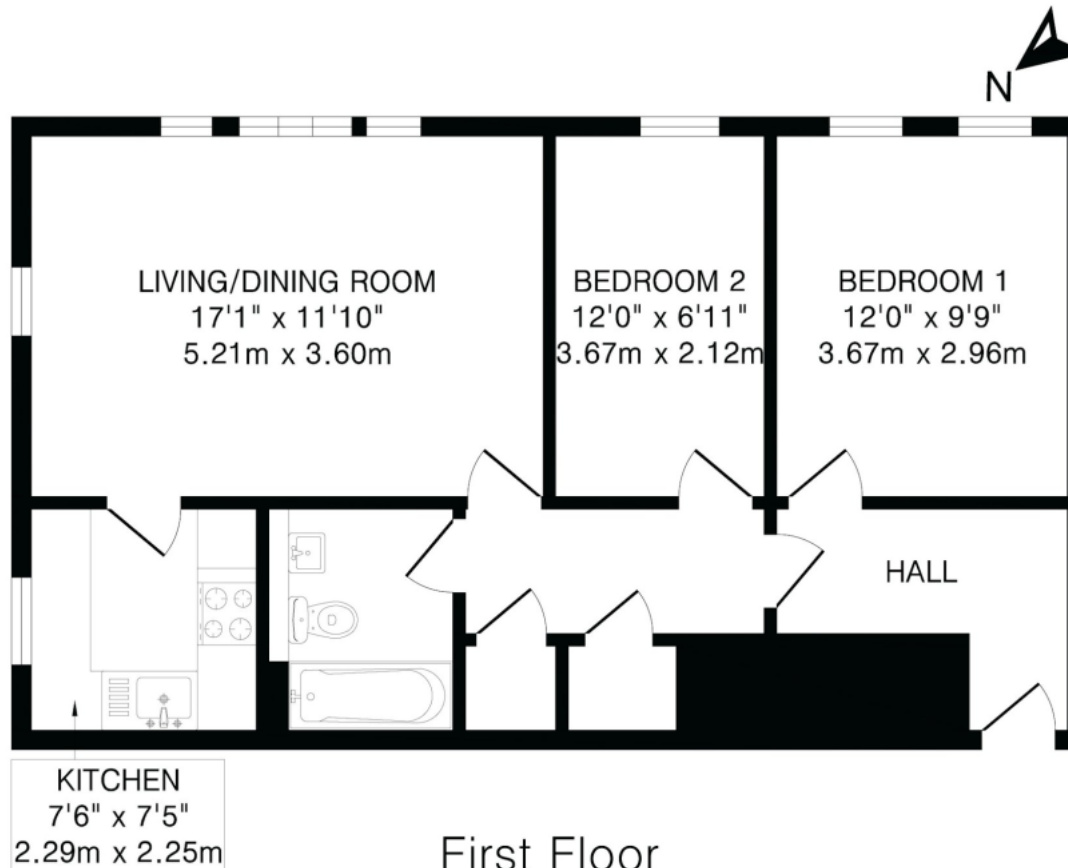

### First Floor

TOTAL FLOOR AREA: 687 sq.ft.(63.8 sq.m)approx.

This floorplan is for illustration purposes only. The measurements and position of each element are approximate and must be viewed as such.

**Important Information** These particulars do not constitute an offer or contract in whole or part. The statements contained herein are made without responsibility on the part of Ashtons or the vendors and they cannot be relied upon as representatives of fact. In respect of floor plans, these are for illustrative purposes only. The measurement and position of each element is approximate and must be viewed as such. Intending purchasers should therefore satisfy themselves by inspection or otherwise as to their correctness. The vendors do not make or give, and neither Ashtons nor any person in their employment has any authority to make or give, any representation or warranty whatsoever in relation to this property. We offer a wide range of services through third party providers including solicitors, surveyors, removal firms, mortgage providers and EPC suppliers. We receive additional payments for administering suppliers quoting software and making referrals. You are not under any obligations to use these services and it is your discretion whether you choose to deal with these parties or your own preferred supplier. You should be aware the average payment we received in 2024 equated to £29.76 per referral.