





-  1 Bedroom
-  1 Bathroom
-  1 Reception
-  EPC Band C

Council Tax Band:  
D £2,342.57 (2025/26)



One bedroom top floor modern apartment a stone's throw from Harpenden Station and Town Centre.

### Description

This bright and airy one-bedroom apartment is ideally located in the heart of the bustling town centre, close to popular bars, restaurants, and the railway line. The open-plan lounge offers a comfortable space, with Velux windows allowing plenty of natural light. The lounge is carpeted, while the kitchen features wooden flooring and integrated appliances. There is a double bedroom, a bathroom with a shower cubicle, and a useful storage cupboard. This lovely apartment also benefits from double-glazed windows and one allocated parking space.

### Location

Arden Court provides easy access to Harpenden's shops and restaurants, perfect for buyers at any life stage. Just a short walk from Harpenden mainline station, it is also close to Rothamsted Park and Harpenden Common.







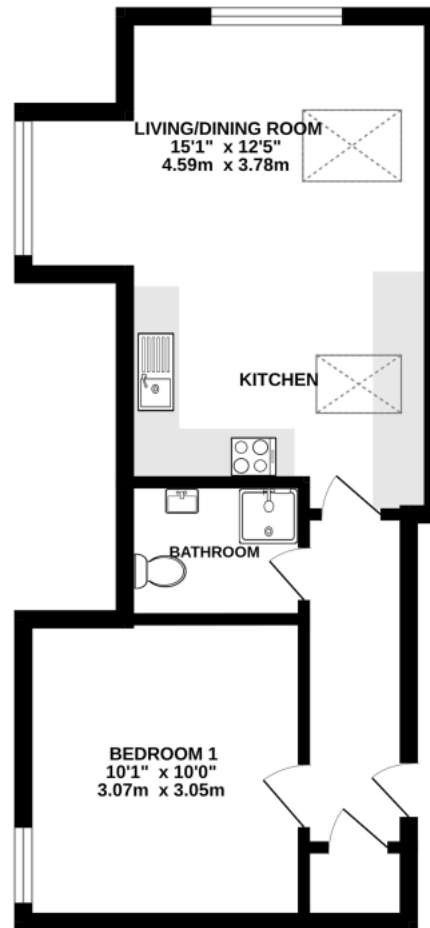

TOTAL FLOOR AREA : 484 sq.ft. (45.0 sq.m.) approx.

This floorplan is for illustration purposes only. The measurements and position of each element are approximate and must be viewed as such.

**Important Information** These particulars do not constitute an offer or contract in whole or part. The statements contained herein are made without responsibility on the part of Ashtons or the vendors and they cannot be relied upon as representatives of fact. In respect of floor plans, these are for illustrative purposes only. The measurement and position of each element is approximate and must be viewed as such. Intending purchasers should therefore satisfy themselves by inspection or otherwise as to their correctness. The vendors do not make or give, and neither Ashtons nor any person in their employment has any authority to make or give, any representation or warranty whatsoever in relation to this property. We offer a wide range of services through third party providers including solicitors, surveyors, removal firms, mortgage providers and EPC suppliers. We receive additional payments for administering suppliers quoting software and making referrals. You are not under any obligations to use these services and it is your discretion whether you choose to deal with these parties or your own preferred supplier. You should be aware the average payment we received in 2024 equated to £29.76 per referral.