

 3 Bedrooms

 1 Bathroom

 1 Reception

 Private Garden

 Driveway

 EPC Band C

Freehold

Council Tax Band:  
C £2,145.77 (2026/2027)

Local Authority:  
North Hertfordshire District Council



 **ashtons**  
for life's great moves

Garden Row, Hitchin, SG5 1QD  
Guide price of £475,000

Stunning Victorian home, short walk to station/town centre.  
Perfect for commuters or first-time buyers, blends classic charm with modern style.

### Description

Approached via a pretty front garden with a herringbone brick pathway and off-road parking, the property offers an attractive first impression. Upon entering, you're welcomed into a bright and spacious open-plan living and dining room, featuring a fireplace with log burner, recessed alcoves, and an understairs storage cupboard, creating a warm heart to the home. To the rear, the kitchen enjoys exposed brick detailing and is fitted with wall and base units, offering ample storage and workspace. An adjoining inner lobby provides additional storage and worktop space, while a door gives access to the rear garden. Completing the ground floor is a modern family bathroom. The first floor offers three bedrooms, including a generous principal bedroom, a second double bedroom, and a third bedroom accessed via the second, ideal as a nursery, dressing room, home office, or occasional bedroom. Outside, the rear garden is hard landscaped for ease of maintenance, complemented by areas of soft planting for seasonal interest.

### Location

Garden Row is a central residential street with easy access to the mainline station and town centre. Nearby, Ransoms Recreational Park offers excellent park facilities and beautiful green space, popular with locals.



In compliance with the UK's Anti Money Laundering (AML) regulations, we are required to confirm the identity of all prospective buyers at the point of an offer being accepted and use a third party, Identity Verification System to do so. There is a nominal charge of £48 (per person) including VAT for this service. For more information, please refer to the terms and conditions section of our website.





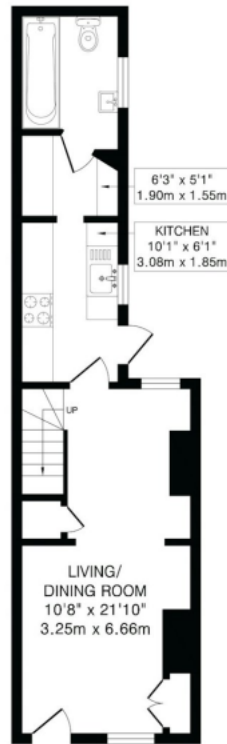

Ground Floor  
376 sq.ft.(34.9 sq.m)approx.



First Floor  
297 sq.ft.(27.5 sq.m)approx.

TOTAL FLOOR AREA: 673 sq.ft.(62.4 sq.m)approx.

This floorplan is for illustration purposes only. The measurements and position of each element are approximate and must be viewed as such.

**Important Information** These particulars do not constitute an offer or contract in whole or part. The statements contained herein are made without responsibility on the part of Ashtons or the vendors and they cannot be relied upon as representatives of fact. In respect of floor plans, these are for illustrative purposes only. The measurement and position of each element is approximate and must be viewed as such. Intending purchasers should therefore satisfy themselves by inspection or otherwise as to their correctness. The vendors do not make or give, and neither Ashtons nor any person in their employment has any authority to make or give, any representation or warranty whatsoever in relation to this property. We offer a wide range of services through third party providers including solicitors, surveyors, removal firms, mortgage providers and EPC suppliers. We receive additional payments for administering suppliers quoting software and making referrals. You are not under any obligations to use these services and it is your discretion whether you choose to deal with these parties or your own preferred supplier. You should be aware the average payment we received in 2024 equated to £29.76 per referral.