 4 Bedrooms

 2 Bathrooms

 2 Receptions

 Private Garden

 On Street

 EPC Band C

Freehold

Council Tax Band:
C £2,145.77 (2026/2027)

Local Authority:
North Hertfordshire District Council



Bearton Road, Hitchin, SG5 1UB
Guide price of £840,000

Extended 4-bed period home with bright interiors, a south-facing garden, and prime location near the station, town centre, and schools.

Description

CHAIN FREE. This beautifully presented family home blends period charm with contemporary living over three floors. The welcoming entrance hall sets the tone, leading to a cosy living room with charming fireplace and bay window. The rear formal dining room, with feature fireplace, flows into an open-plan kitchen/family room, bathed in light, with bi-folds opening to the patio. The kitchen boasts modern units and integrated appliances. The first floor offers two double bedrooms and a modern bathroom, with the principal bedroom featuring an en-suite. The second floor provides two spacious bedrooms and eaves storage. The front garden features soft planting, while the rear garden enjoys a southerly aspect with a patio, shingled seating area, and lawn bordered by plants and trees. A wooden shed offers additional storage. ** Disclaimer ** Japanese Knotweed located at the back of the garden is under treatment. Contact us for more information.

Location

Bearton Road, SG5 1, is famed for its proximity to outstanding schools, the mainline station, and the historic town centre. The street features a blend of charming Victorian, Edwardian, and 1930s-style homes, enhancing the area's aesthetic appeal.



In compliance with the UK's Anti Money Laundering (AML) regulations, we are required to confirm the identity of all prospective buyers at the point of an offer being accepted and use a third party, Identity Verification System to do so. There is a nominal charge of £48 (per person) including VAT for this service. For more information, please refer to the terms and conditions section of our website.





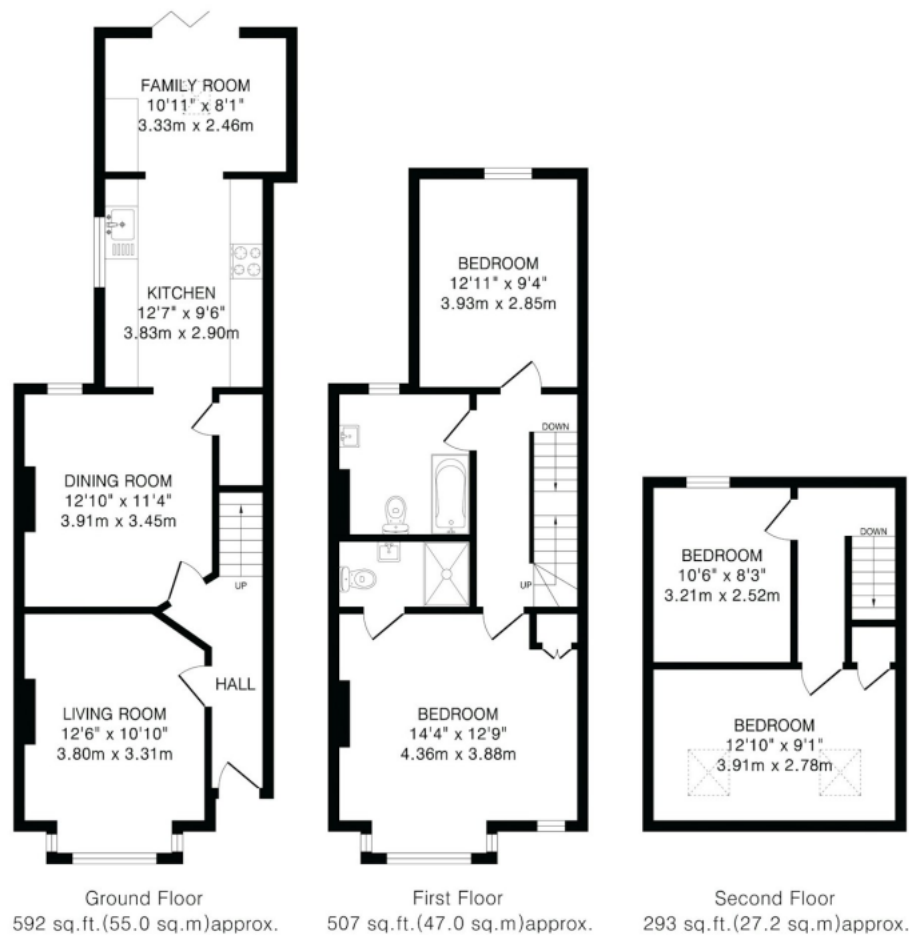

TOTAL FLOOR AREA: 1392 sq.ft.(129.2 sq.m)approx.
 This floorplan is for illustration purposes only. The measurements and position of each element are approximate and must be viewed as such.

Important Information These particulars do not constitute an offer or contract in whole or part. The statements contained herein are made without responsibility on the part of Ashtons or the vendors and they cannot be relied upon as representatives of fact. In respect of floor plans, these are for illustrative purposes only. The measurement and position of each element is approximate and must be viewed as such. Intending purchasers should therefore satisfy themselves by inspection or otherwise as to their correctness. The vendors do not make or give, and neither Ashtons nor any person in their employment has any authority to make or give, any representation or warranty whatsoever in relation to this property. We offer a wide range of services through third party providers including solicitors, surveyors, removal firms, mortgage providers and EPC suppliers. We receive additional payments for administering suppliers quoting software and making referrals. You are not under any obligations to use these services and it is your discretion whether you choose to deal with these parties or your own preferred supplier. You should be aware the average payment we received in 2024 equated to £29.76 per referral.