



4 bedrooms



2 bathrooms



2 receptions



Private Garden



Garage/Off Street



EPC Band D

Council Tax Band:
G £4,072.75 (2025/26)

Local Authority:
Aylesbury Vale



Spectacular 4-bed detached home in a desirable location with generous living space, modern design, and far-reaching views.

Description

This deceptively spacious, detached family home offers well-planned living spaces on a 0.4-acre plot with stunning countryside views. Located in an Area of Outstanding Natural Beauty near Tring and Wendover, the property features versatile accommodation over two floors, with potential for rear and loft extensions, subject to planning consent. Upon entry, you'll notice the high-quality finish. The ground floor comprises a welcoming hallway leading to an open plan kitchen/dining/family room, sitting room, utility, and cloakroom. The sitting room has bifold doors to the terrace, while the kitchen boasts a central island, wood burner, and patio doors with breathtaking views. The first floor hosts a principal bedroom with en suite and built-in wardrobes, alongside three bedrooms and a family bathroom. The property includes a large driveway, ample parking, side access, and a sizable garage. The rear garden exceeds 200ft, mainly lawned with terraced areas and numerous fruit trees. Located within the Aylesbury grammar schools catchment area.

Location

Aston Clinton is a charming village in Buckinghamshire, located near the Chiltern Hills. It offers a mix of historic character and modern convenience, with local pubs, cafes, a primary school, and a popular park featuring a café, skate park, and play



Buyers Information: - In compliance with the UK's Anti Money Laundering (AML) regulations, we are required to confirm the identity of all prospective buyers at the point of an offer being accepted and use a third party, Identity Verification System to do so. There is a nominal charge of £48 (per person) including VAT for this service. For more information, please refer to the terms and conditions section of our website.





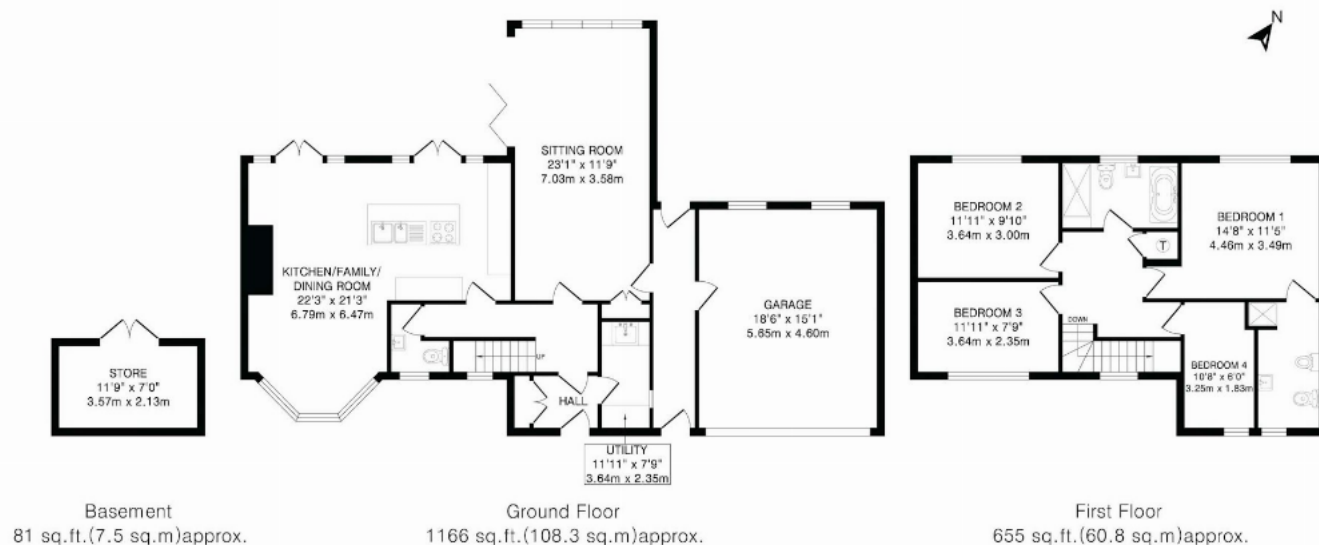

TOTAL FLOOR AREA: 1902 sq.ft. (176.6 sq.m) approx.
 This floorplan is for illustration purposes only. The measurements and position of each element are approximate and must be viewed as such.

Important Information These particulars do not constitute an offer or contract in whole or part. The statements contained herein are made without responsibility on the part of Ashtons or the vendors and they cannot be relied upon as representatives of fact. In respect of floor plans, these are for illustrative purposes only. The measurement and position of each element is approximate and must be viewed as such. Intending purchasers should therefore satisfy themselves by inspection or otherwise as to their correctness. The vendors do not make or give, and neither Ashtons nor any person in their employment has any authority to make or give, any representation or warranty whatsoever in relation to this property. We offer a wide range of services through third party providers including solicitors, surveyors, removal firms, mortgage providers and EPC suppliers. We receive additional payments for administering suppliers quoting software and making referrals. You are not under any obligations to use these services and it is your discretion whether you choose to deal with these parties or your own preferred supplier. You should be aware the average payment we received in 2024 equated to £29.76 per referral.