



5 bedrooms



1 bathroom



2 receptions



EPC Band D

Freehold

Council Tax Band:
G £3,883.96 (25/26)

Local Authority:
Dacorum



Attractive 5-bed Victorian house in Berkhamsted, central road off High St. 2200sqft, period features, scope to enlarge, parking, no upper chain.

Description

This Victorian house on a central Berkhamsted road offers a unique charm with its wider-than-average plot. It features parking space and a side-return, providing potential for future enhancements. The first floor is larger due to extra space. High ceilings and period features add character, while the spacious west-facing rear garden enjoys evening sun. This 'halls-adjointing' semi boasts a grand hallway, leading to a basement. The living room has a bay window, and the family room overlooks the garden. A downstairs cloakroom and utility room add convenience, while the well-lit kitchen, complete with an AGA cooker, is open to the dining room, perfect for entertaining with French doors to the garden. The first floor presents spacious rooms and further enhancement opportunities. The principal bedroom is roomy with wardrobes and a bay window. Bedroom five and a spare room could form a suite with an ensuite and dressing room. Four additional bedrooms, a family bathroom, and a third w/c complete this floor. The west-facing garden includes a lawn, shrubs, a paved patio, and a greenhouse.

Location

Located on prestigious Boxwell Road, Berkhamsted, this property is surrounded by period homes and excellent schools. Close to the High Street and train station, with nearby shops like M&S Foodhall and Waitrose enhancing the vibrant local lifestyle.



Buyers Information: - In compliance with the UK's Anti Money Laundering (AML) regulations, we are required to confirm the identity of all prospective buyers at the point of an offer being accepted and use a third party, Identity Verification System to do so. There is a nominal charge of £48 (per person) including VAT for this service. For more information, please refer to the terms and conditions section of our website.





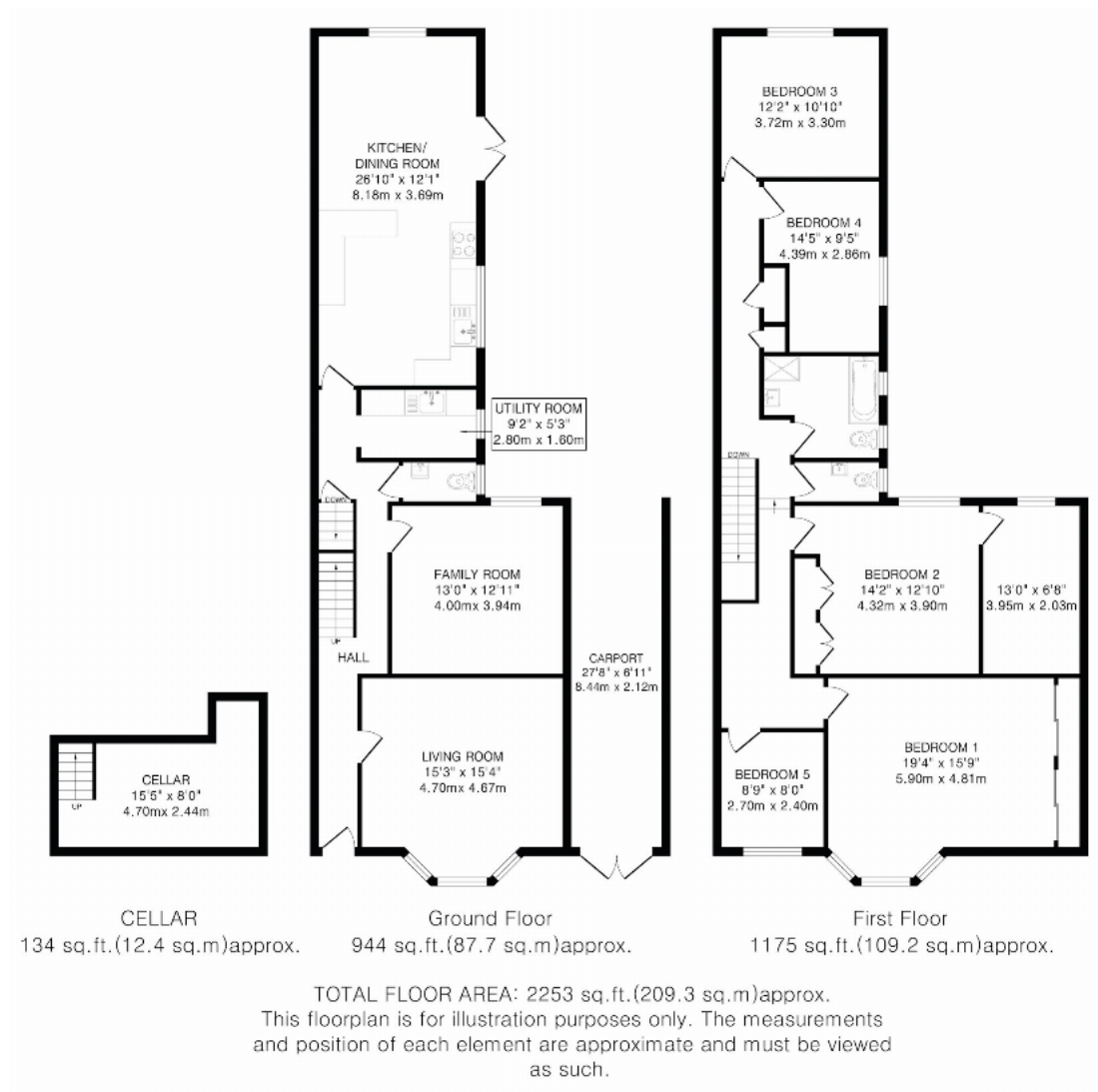

Important Information These particulars do not constitute an offer or contract in whole or part. The statements contained herein are made without responsibility on the part of Ashtons or the vendors and they cannot be relied upon as representatives of fact. In respect of floor plans, these are for illustrative purposes only. The measurement and position of each element is approximate and must be viewed as such. Intending purchasers should therefore satisfy themselves by inspection or otherwise as to their correctness. The vendors do not make or give, and neither Ashtons nor any person in their employment has any authority to make or give, any representation or warranty whatsoever in relation to this property. We offer a wide range of services through third party providers including solicitors, surveyors, removal firms, mortgage providers and EPC suppliers. We receive additional payments for administering suppliers quoting software and making referrals. You are not under any obligations to use these services and it is your discretion whether you choose to deal with these parties or your own preferred supplier. You should be aware the average payment we received in 2024 equated to £29.76 per referral.